



Ordinary Council Meeting

18th August 2015



Papers Relating

CONTENTS

<u>Item Number</u>	<u>Report</u>
10.1.1	Mining Application Mt Henry Gold 63/69 & 63/71
10.1.2	Mining Application Australian Strategic and Precious Metals Investments Pty Ltd
10.1.3	State Heritage - Holy Trinity Church Norseman
10.3.1	Change in Electoral Boundaries
10.3.2	MOU Kalgoorlie Boulder Visitor Centre
10.3.3	RV Friendly Town
10.3.4	Officers Reports



10.1.1

Mining Application
Mt Henry Gold 63/69 & 63/71



Enquiries: Deborah Szymeczko
E-mail: Deb.Szymeczko@dmp.wa.gov.au

Mr Richard Brookes
Chief Executive Officer
Shire of Dundas
88-92 Prinsep Street
NORSEMAN WA 6443

Dear Richard,

FILE NUMBER	RV.VA.2
RECORD NUMBER	ICR20571606
PRESIDENT	
GEO	✓
DCEO	
HEALTH / BUILDING	
WORKS	
FINANCE	
RATES	
PAYROLL	
PROJECT OFFICER	
LIBRARY	
CRC	
YOUTH	
COM LEVEL	

90.15
02

**APPLICATION FOR MISCELLANEOUS LICENCE 63/69
BY MT HENRY GOLD PTY LTD and AUSTRALIAN STRATEGIC AND PRECIOUS
METALS INVESTMENTS PTY LTD
SITUATED ON COOLGARDIE ESPERANCE ROAD RESERVE**

Under Sections 23 to 26 of the Mining Act 1978 mining may be carried out on certain classes of land with the written consent of the Hon Minister for Mines and Petroleum.

In respect to road reserve, the Minister for Mines and Petroleum is to first consult and obtain the recommendation of the local municipality and the Minister for Lands before he can grant consent to mine.

The Minister for Mines and Petroleum has therefore directed that I commence the consultation process and obtain your Council's comments and recommendation with regard to the impact of the application on the reserve listed above.

I have enclosed a copy and plan of the application for this purpose.

Your reply in due course would be appreciated please.

Yours faithfully

ACTING MINING REGISTRAR
NORSEMAN
28TH July 2015

Form 21

WESTERN AUSTRALIA
Mining Act 1978
(Secs. 41, 58, 70C, 74, 86, 91, Reg. 64)

APPLICATION FOR MINING TENEMENT

(a) Type of tenement	(a) Miscellaneous Licence	No. L 63/69
(b) Time & Date marked out (where applicable)		
(c) Mineral Field	(b) a.m./p.m. / /	(c) DUNDAS
For each applicant:		
(d) Full Name and ACN/ABN	(d) and (e) MT HENRY GOLD PTY LTD (ACN: 159 128 140) PO BOX Z5487, PERTH, WA, 6831	(f) Shares 70
(e) Address		
(f) No. of shares	AUSTRALIAN STRATEGIC AND PRECIOUS METALS INVESTMENT PTY LTD (ACN: 089 489 645)	30
(g) Total No. of shares	CA- MT HENRY GOLD MINE PTY LTD, PO BOX Z5487, PERTH, WA, 6831	
		(g) Total 100
DESCRIPTION OF GROUND APPLIED FOR: (For Exploration Licences see Note 1. For other Licences see Note 2. For all Licences see Note 3.)	(h) Dundas (i) Datum situated at GDA94 Zone 51 coordinates 382125.18 mE 6414723.85 mN (j) Thence point 2 382499.73 mE 6414723.85 mN Thence point 3 382499.73 mE 6414221.53 mN Thence point 4 383549.87 mE 6414221.53 mN Thence point 5 383549.87 mE 6413982.49 mN Thence point 6 382125.18 mE 6413982.49 mN Thence back to datum 382125.18 mE 6414723.85 mN Purposes: a bore , a bore field , a minesite accommodation facility , a pipeline , a power generation and transmission facility , a power line , a road , a water management facility and taking water.	
(h) Locality		
(i) Datum Peg		
(j) Boundaries		
(k) Area (ha or km ²)	(k) 55.71000 HA	
(l) Signature of applicant or agent (if agent state full name and address)	(l) Yvonne Weissgerber 86 FIRST AVE, MOUNT LAWLEY, WA, 6050	Date: 12/12/2014

OFFICIAL USE

A NOTICE OF OBJECTION may be lodged at any mining registrar's office on or before the 16th day of January 2015 (See Note 4).

Where an objection to this application is lodged the hearing will take place on a date to be set.

Received at	11:06:41	on 12 December	2014	with fees of
Application	\$451.10			
Rent	\$798.00			
TOTAL	\$1,249.10			
Receipt No:	434614427130			

Mining Registrar

NOTES

Note 1: EXPLORATION LICENCE

- (i) Attachments 1 and 2 form part of every application for an exploration licence and must be lodged with this form in lieu of (h), (i), (j) and (k) above.
- (ii) An application for an Exploration Licence shall be accompanied by a statement specifying method of exploration, details of the proposed work programme, estimated cost of exploration and technical and financial ability of the applicant(s).

Note 2: PROSPECTING/MISCELLANEOUS LICENCE AND MINING/GENERAL PURPOSE LEASE

- (i) This application form shall be accompanied by a map on which are clearly delineated the boundaries of the area applied for.

Note 3: GROUND AVAILABILITY

- (i) The onus is on the applicant to ensure that ground is available to be marked out and/or applied for.
- (ii) The following action should be taken to ascertain ground availability:
(a) public plan search; (b) register search; (c) ground inspection.

Note 4: ALL APPLICATIONS OVER PRIVATE LAND

The period for lodgement of an objection is within 21 days of service of this notice, or the date noted above for lodging objections, whichever is the longer period.



381000mE

382000mE

383000mE

384000mE

-32°23'

-32°24'

-32°25'

641600mN

641500mN

641400mN

641300mN

641200mN

P 63/1454

P 63/1455

P 63/1456

P 63/1457

P 63/1458

NORSEMA

NOR 64A

P 63/1427

DUNDAS RD

Noganyer Soak

P 63/1569

NOR 34

P 63/1564

DUNDAS

P 63/1565

L 63/69

NOR 35

VCL

▲4297
Rubbish Depot

P 63/1566

Boragina S

Ancillary Doclid: **190364**
Capture Date: 15/12/2014 13:52:59
Capture Office: NORSEMAN
Lead Tenement: L 63/69



em-a-190364

P 5H/26

P 63/1567

121°45'

121°46'

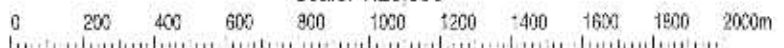



Enquiries: Deborah Szymeczko
E-mail: Deb.Szymeczko@dmp.wa.gov.au

Mr Richard Brookes
Chief Executive Officer
Shire of Dundas
88-92 Prinsep Street
NORSEMAN WA 6443

	COM DEVEL
	ADULT
	PROJ
	LIBRARY
	PROJECT CHIEFER
	PARADE
	RAILS
	FINANCE
	WORKS
	HEALTH/BUILDING
	DEPT
	DEPT
	INDUSTRIAL
5091610707	NUMBER
	NUMBER
RV VA 12	

RECEIVED
29 JUL 2015

D2
90.15

Dear Richard,

**APPLICATION FOR MISCELLANEOUS LICENCE 63/71
BY MT HENRY GOLD PTY LTD and AUSTRALIAN STRATEGIC AND PRECIOUS
METALS INVESTMENTS PTY LTD
SITUATED ON COOLGARDIE ESPERANCE ROAD RESERVE**

Under Sections 23 to 26 of the Mining Act 1978 mining may be carried out on certain classes of land with the written consent of the Hon Minister for Mines and Petroleum.

In respect to road reserve, the Minister for Mines and Petroleum is to first consult and obtain the recommendation of the local municipality and the Minister for Lands before he can grant consent to mine.

The Minister for Mines and Petroleum has therefore directed that I commence the consultation process and obtain your Council's comments and recommendation with regard to the impact of the application on the reserve listed above.

I have enclosed a copy and plan of the application for this purpose.

Your reply in due course would be appreciated please.

Yours faithfully

ACTING MINING REGISTRAR
NORSEMAN
28TH July 2015

Form 21

WESTERN AUSTRALIA
Mining Act 1978
(Secs. 41, 58, 70C, 74, 86, 91, Reg. 64)

APPLICATION FOR MINING TENEMENT

(a) Type of tenement	(a) Miscellaneous Licence		No. L 63/71
(b) Time & Date marked out (where applicable)	(b) a.m./p.m. / /		(c) DUNDAS
(c) Mineral Field			
For each applicant:	(d) and (e)		(f) Shares
(d) Full Name and ACN/ABN	MT HENRY GOLD PTY LTD (ACN: 159 128 140) PO BOX Z5487, PERTH, WA, 6831		70
(e) Address	AUSTRALIAN STRATEGIC AND PRECIOUS METALS INVESTMENT PTY LTD (ACN: 089 489 645) C/- MT HENRY GOLD MINE PTY LTD, PO BOX Z5487, PERTH, WA, 6831		30
(f) No. of shares			
(g) Total No. of shares			(g) Total 100
DESCRIPTION OF GROUND APPLIED FOR: (For Exploration Licences see Note 1. For other Licences see Note 2. For all Licences see Note 3.)	(h) Dundas (i) Datum situated at GDA94 Zone 51 coordinates 383076.07 mE 6416153.94 mN (j) Thence point 2 383480.52 mE 6416153.94 Thence point 3 383480.52 mE 6415058.00 Thence point 4 384061.86 mE 6414628.86 Thence point 5 383686.49 mE 6414628.86 Thence point 6 383076.07 mE 6415139.06 Thence back to datum 383076.07 mE 6416153.94 Purposes: a bore , a bore field , a pipeline , a power line , a road , and taking water.		
(n) Locality			
(o) Datum Peg			
(p) Boundaries			
(k) Area (ha or km ²)	(k) 58.66000 HA		
(l) Signature of applicant or agent (if agent state full name and address)	(l) Yvonne Weissgerber 86 FIRST AVE, MOUNT LAWLEY, WA, 6050		Date: 12/12/2014

OFFICIAL USE

A NOTICE OF OBJECTION may be lodged at any mining registrar's office on or before the 16th day of January 2015 (See Note 4).

Where an objection to this application is lodged the hearing will take place on a date to be set.

Received at	11:06:41	on	12 December	2014	with fees of
Application	\$451.10				
Rent	\$840.75				
TOTAL	\$1,291.85				
Receipt No:	434614427130				

Mining Registrar

NOTES

Note 1: EXPLORATION LICENCE

- (i) Attachments 1 and 2 form part of every application for an exploration licence and must be lodged with this form in lieu of (h), (i), (j) and (k) above.
- (ii) An application for an Exploration Licence shall be accompanied by a statement specifying method of exploration, details of the proposed work programme, estimated cost of exploration and technical and financial ability of the applicant(s).

Note 2: PROSPECTING/MISCELLANEOUS LICENCE AND MINING/GENERAL PURPOSE LEASE

- (i) This application form shall be accompanied by a map on which are clearly delineated the boundaries of the area applied for.

Note 3: GROUND AVAILABILITY

- (i) The onus is on the applicant to ensure that ground is available to be marked out and/or applied for.
- (ii) The following action should be taken to ascertain ground availability:
 - (a) public plan search; (b) register search; (c) ground inspection.

Note 4: ALL APPLICATIONS OVER PRIVATE LAND

The period for lodgement of an objection is within 21 days of service of this notice, or the date noted above for lodging objections, whichever is the longer period.

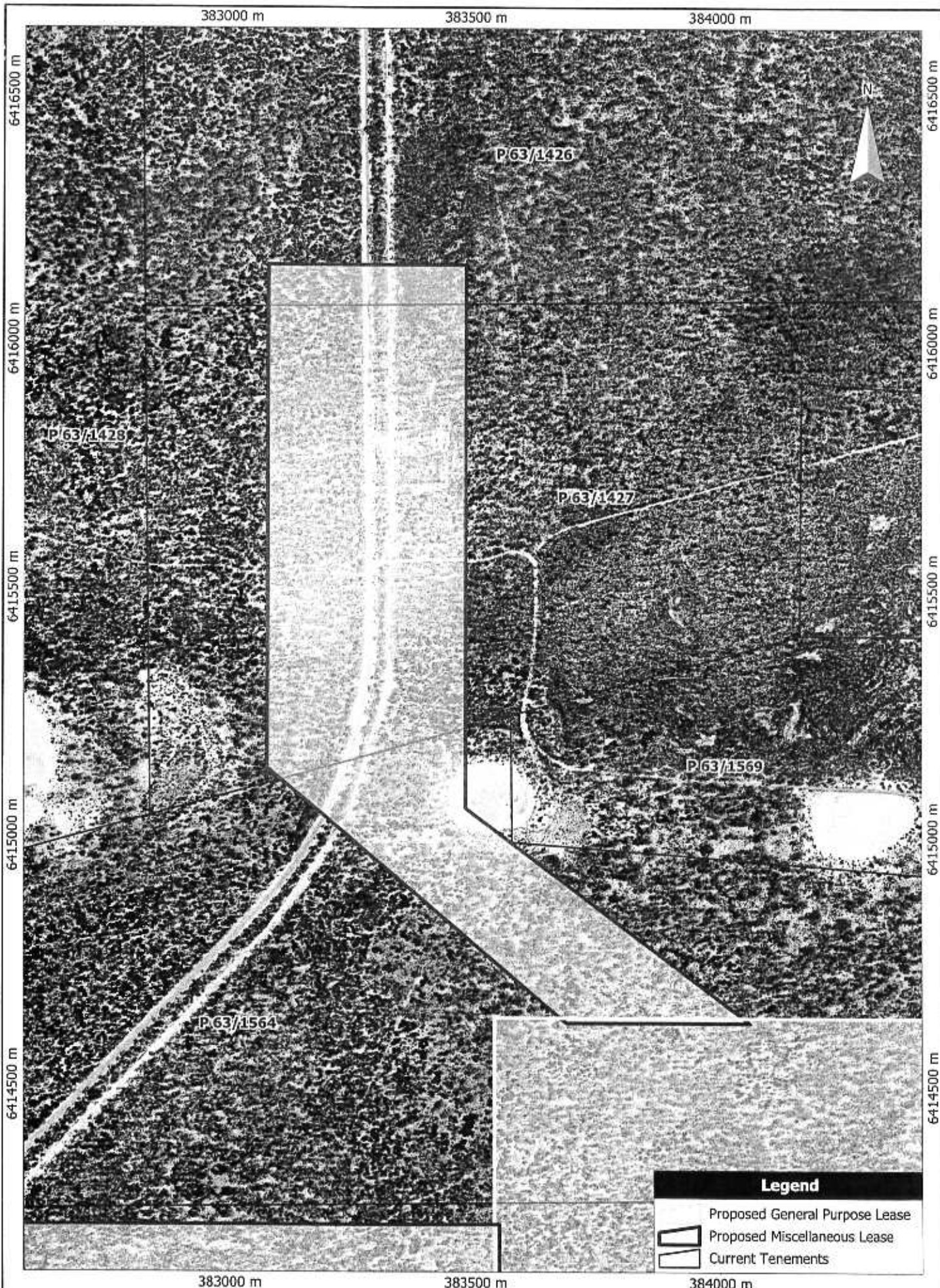

Scale: 1:10000
 Original Size: A4
 Air Photo Date: 2013
 Grid: Australia MGA94 (51)
 0

Panoramic Resources
 Limited
 Mt Henry Gold Project

Figure
**Proposed Miscellaneous
 Lease 2**

Martinox Bosch Sell Pty Ltd
 4 Cook St
 West Perth, WA 6005
 Ph: (08) 9226 3166
 Fax: (08) 9226 3177
 info@mbsenvironmental.com.au
 www.mbsenvironmental.com.au





380000mE

382000mE

384000mE

386000mE

-32°21'

-32°22'

-32°23'

-32°24'

-32°25'

-32°26'

642000mN

641800mN

641600mN

641400mN

641200mN

121°44'

121°45'

121°46'

121°47'

121°48'

This plan has been compiled from a number of sources and does not represent a survey. It is not intended to be used for legal purposes. The Department of Mines and Petroleum is not responsible for any errors or omissions. The Department of Mines and Petroleum is not responsible for any errors or omissions. The Department of Mines and Petroleum is not responsible for any errors or omissions.

Scale: 1:40,000

0 400 800 1200 1600 2000 2400 2800 3200 3600 4000m

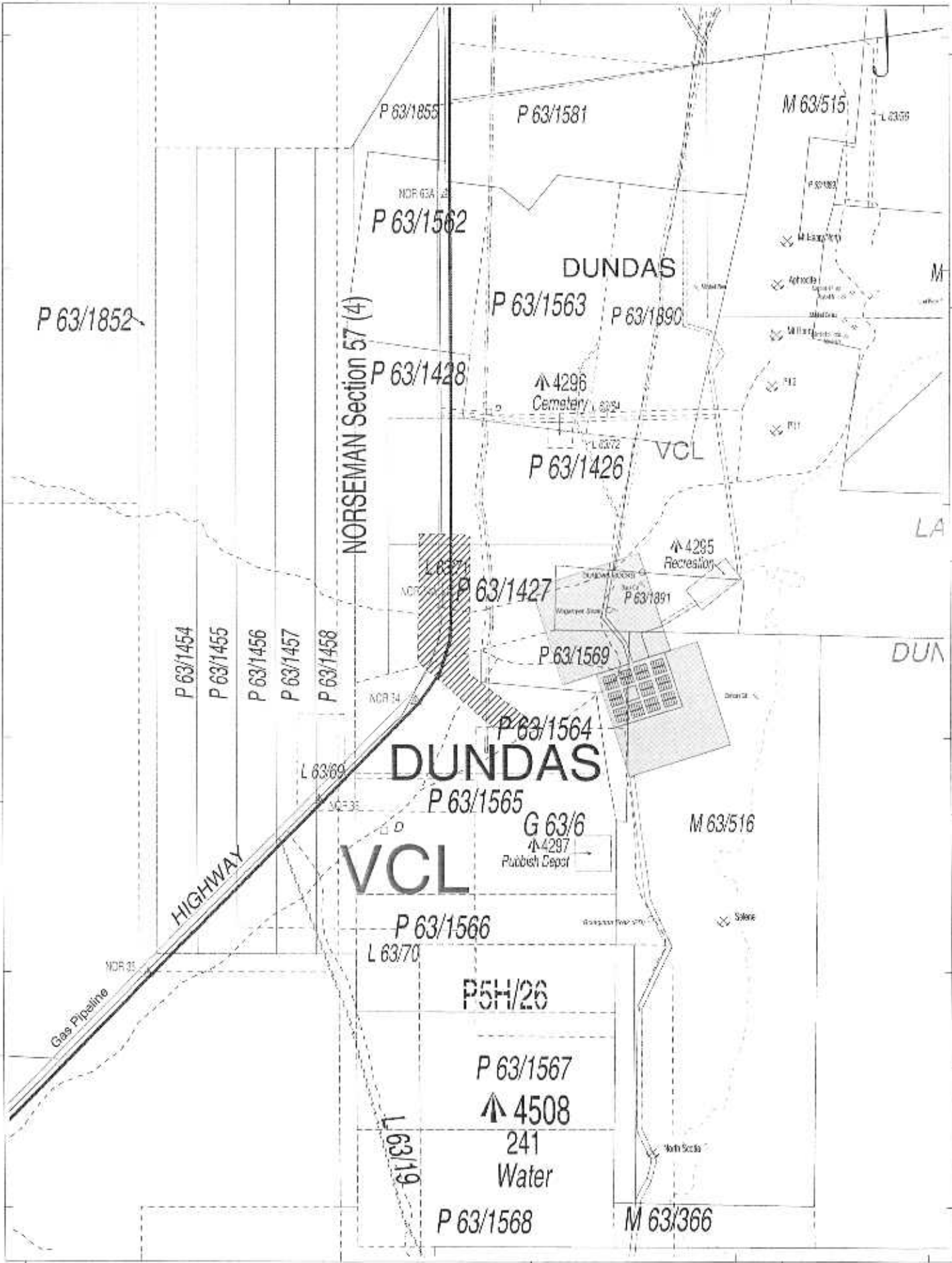



10.1.2

Mining Application
Australian Strategic and Precious Metals
Investments Pty Ltd



Enquiries: Deborah Szymeczko
E-mail: Deb.Szymeczko@dmp.wa.gov.au

FILE NUMBER	RV.VA.2
RECORD NUMBER	1CR20157160
PRESIDENT	
CEO	✓
DCED	
HEALTH / BUILDING	
WORKS	
FINANCE	
RATES	
PAYROLL	
PROJECT OFFICER	
LIBRARY	
CRG	
YOUTH	
COMM DEVEL	

02
90.15

Mr Richard Brookes
Chief Executive Officer
Shire of Dundas
88-95 Prinsep Street
NORSEMAN WA 6443

Dear Richard,

**APPLICATION FOR MISCELLANEOUS LICENCE 63/65
BY AUSTRALIAN STRATEGIC AND PRECIOUS METALS INVESTMENTS P/L
SITUATED ON OLD COACH ROAD RESERVE
PURPOSE : ROAD AND PIPELINE**

The original submission was sent to the Shire of Dundas on 8th January 2015. Since then the applicant has requested that a pipeline be added to the purpose of the miscellaneous licence. Therefore we seek a further review of the application in regard to comments and recommendations.

Under Sections 23 to 26 of the Mining Act 1978 mining may be carried out on certain classes of land with the written consent of the Hon Minister for Mines and Petroleum.

In respect to road reserve, the Minister for Mines and Petroleum is to first consult and obtain the recommendation of the local municipality and the Minister for Lands before he can grant consent to mine.

The Minister for Mines and Petroleum has therefore directed that I commence the consultation process and obtain your Council's comments and recommendation with regard to the impact of the application on the reserve listed above.

I have enclosed a copy and plan of the application for this purpose.

Your reply in due course would be appreciated please.

Yours faithfully

ACTING MINING REGISTRAR
28TH July 2015

Form 21

WESTERN AUSTRALIA
Mining Act, 1978
(Secs. 41, 56, 72c, 74, 86, 91 Reg. 64)

APPLICATION FOR MINING TENEMENT

- (a) Type of tenement
- (b) Time & Date marked out (where applicable)
- (c) Mineral Field

(a)	Miscellaneous Licence - for the purpose of "Road"	No <u>63/65</u>
(b)	10:00 a.m. 27/7/2009	(c) Dundas

APPLICANT

- (d) Full name) for
- (e) Address) each
- (f) No. of shares) applica-
- part

(d) & (e)	Australian Strategic & Precious Metals Investment Pty Ltd C/- Tenement Administration Services Pty Ltd Level 2, 326 Hay Street EAST PERTH WA 6004	(f) Shares 100
(g) Total no. of shares	Total	100

DESCRIPTION OF GROUND APPLIED FOR

- (h) Locality
- (i) Datum Peg or Starting Point
- (j) Boundaries

(h) Old Coach Road

(i) Datum situated at GDA94 Zone 51 coordinates 6411086 mN 384960 mE

(j) Thence to:

6410928 mN 384876mE,	6410336 mN 384807mE,
6410168 mN 384764mE,	6409706 mN 384215mE,
6409582 mN 384104mE,	6409578 mN 384092mE,
6409563 mN 384109mE,	6409447 mN 383763mE,
6409439 mN 383540mE,	6409499 mN 383539mE,
6409507 mN 383752mE,	6409617 mN 384081mE,
6409735 mN 384187mE,	6410191 mN 384729mE,
6410344 mN 384787mE,	6410938 mN 384836mE,
6411101 mN 384922mE,	6411086 mN 384960mE; Back to Datum.

(k) Area (ha or m²) **10.78 Ha**

- (l) Signature of applicant or Agent

(l)  DATE 28-7 2009
Tenement Administration Services Pty Ltd as AGENT

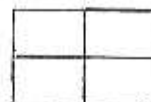
O F F I C E U S E	OBJECTIONS to this application may be lodged at the office of the mining registrar at NORSEMAN on or before the <u>15th</u> day of <u>SEPTEMBER</u> 2009		
		FEES PAID Application \$ <u>375.00</u> ✓ Rent \$ <u>138.60</u> ✓ TOTAL \$ <u>513.60</u> ✓	Receipt No: <u>3129</u> Shire: <u>DUNDAS</u>
	MINING REGISTRAR 28 JUL 2009 NORSEMAN	Received at <u>12:10</u> P.m on <u>28.07.2009</u> <u>D. VICENSONI & C.</u> (Mining Registrar)	
			Map ref.  Plan: TENGRAPH Scale

COPYRIGHT



Department of
Mines and Petroleum



Map Grid of Australia, 1994 - Zone 51

TENGRAPH (c) 1992, 1993

02:33 PM, 27/07/2009

[Customized Screen] EX20581 PERTM099

383500mE

384000mE

384500mE

385000mE

Water & Stopping Place Datum

FNA/1194

1568

Scotia N

M

GAF

6411500mN

6411000mN

6411500mN

6411000mN

6410500mN

6410000mN

6409500mN

121°48'

121°46'30"

Scale: 1:10,000

0 100 200 300 400 500 600 700 800 900 1000m

This data has been derived from original data sources provided to us by the Department of Mines and Petroleum. It is provided as a service to our clients and is not intended to be used for any other purpose. The Department of Mines and Petroleum is not responsible for any errors or omissions. The Department of Mines and Petroleum is not responsible for any errors or omissions. The Department of Mines and Petroleum is not responsible for any errors or omissions. The Department of Mines and Petroleum is not responsible for any errors or omissions.



382000mE

384000mE

386000mE

6414000mN

6412000mN

6410000mN

6408000mN

32°25'

32°26'

32°27'

32°28'

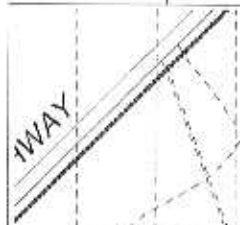

VCL

G 63/6
▲4297
Rubbish Depot

M 63/516

P 63/1566

L 63/70

P5H/26

P 63/1567

▲4508

241
Water

L 63/19

P 63/1568

M 63/366

210

DUNDAS M.R.S

L 63/65

VCL
160

63/1401

VCL
159

VCL
162

VCL
161

M 63/36

M

121°45'

121°46'

121°47'

The data on this map is derived from the cadastral information provided by the Department of Mines and Petroleum. It is not intended to be used for any other purpose. The Department of Mines and Petroleum is not responsible for any errors or omissions. The Department of Mines and Petroleum is not responsible for any damage or loss resulting from the use of this map. The Department of Mines and Petroleum is not responsible for any damage or loss resulting from the use of this map. The Department of Mines and Petroleum is not responsible for any damage or loss resulting from the use of this map.

Scale: 1:30,000

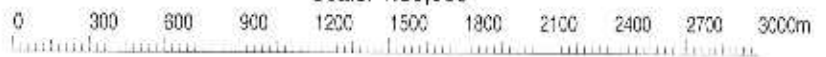



10.1.3

State Heritage
Holy Trinity Church Norseman



Working on behalf of the Heritage Council to recognise, conserve, adapt and celebrate our State's unique cultural heritage

21 July 2015

FILE NUMBER	GR 5L 26
RECORD NUMBER	KR201571594 07
PRESIDENT	67.4
CEO	✓
DCED	
HEALTH / BUILDING	
WORKS	
FINANCE	
RATES	
RECYCLE	
PROJECT OFFICER	
LIBRARY	
CRC	
YOUTH	
COMMUNITY	

YOUR REF
OUR REF P762
ENQUIRIES Moss Wilson / 6552 4000

Mr Richard Brookes
Chief Executive Officer
Shire of Dundas
PO Box 163
NORSEMAN WA 6448

Dear Mr Brookes

**P762 Holy Trinity Church, Norseman, 100 Angove Street, Norseman
Lot 34 on Deposited Plan 222908 being the whole of the land in Certificate of
Title Volume 85 Folio 91**

The Heritage Council's Register Committee recently resolved that the above place is of cultural heritage significance in terms of the *Heritage of Western Australia Act 1990*, and that stakeholders should be consulted on the proposed registration.

We are therefore seeking your written comments on the proposed entry of *Holy Trinity Church, Norseman* in the State Register of Heritage Places. The register entry will be based on the three enclosed documents, so please read these carefully:

- Draft assessment documentation
- HCWA Curtilage Map – showing the area of land that is proposed to be registered
- HCWA Zones of significance – showing level of significance of the various areas

Please make your submission using the attached form. If you would like to provide additional comments or information, these can be submitted in a separate attachment. Please send your submission to us by post or fax, or email info@stateheritage.wa.gov.au by **Tuesday 1 September 2015**.

The *Heritage of Western Australia Act 1990* (Sections 23 [4] and [5]) requires that the relevant local government be invited to nominate a person to attend the meeting at which the proposed registration of a place will be considered. It is entirely your decision whether you nominate someone to attend.

If you choose to nominate an attendee, they become a voting member of the Register Committee when *Holy Trinity Church, Norseman* is considered. At the meeting your nominee will be asked to present the views of the local

www.stateheritage.wa.gov.au
info@stateheritage.wa.gov.au

government on the proposed registration. Further material including the recommendation to be considered by the Register Committee will be provided to your nominated attendee once a meeting has been scheduled.

The decision of the Register Committee is confidential until your Council has been officially notified. Should you have any queries relating to these confidentiality provisions, please do not hesitate to contact me on 6552 4000.

Please indicate whether you would like to attend this meeting on the attached form, and you will be notified of the meeting date once scheduled if you have opted to attend.

Please note that the owner listed on page one of the assessment documentation have also been asked to comment on the proposed registration.

If you would like more time to consider the documentation, or to discuss registration, please contact Senior Heritage Officer Moss Wilson on 6552 4000 or the above email. We would also be happy to meet with you to discuss the proposed entry of *Holy Trinity Church, Norseman* in the State Register. We look forward to hearing from you.

Yours sincerely



P.P. Penny O'Connor
Director Assessment and Registration
Enc



STATE
HERITAGE
OFFICE

Bairds Building 491 Wellington Street Perth
Tel (08) 6552 4000
Fax (08) 6552 4001
info@stateheritage.wa.gov.au

TO:

FROM:

RE:

DATE:

I/We refer to your letter of 21 July 2015, advising that the following place is to be considered for entry into the Register of Heritage Places:

P762 Holy Trinity Church, Norseman

As the relevant municipal Council for the above place, I/We _____
(✓ applicable box)

- support the proposed registration**
- have no comment to make on the proposal**
- do not support the proposed registration**

Please provide comments here or attach a separate submission:

- I agree for other stakeholders to be advised of our position on registration**

The Council **does/does not*** wish to attend the Heritage Council meeting during which the interim registration of the above place will be considered. (*delete whichever does not apply)

Signed: _____

Name: _____

Position: _____



STATE
HERITAGE
OFFICE

LOCAL GOVERNMENT REPRESENTATIVE PARTICIPATION IN A MEETING OF THE REGISTER COMMITTEE OF THE HERITAGE COUNCIL OF WESTERN AUSTRALIA

The Register Committee of the Heritage Council of WA is pleased to invite you to participate in its deliberations about and determination on a place under consideration for entry in the State Register of Heritage Places. This invitation is extended under Sections 23 (4) and (5) of the *Heritage of Western Australia Act 1990*.

Being invited to participate means that you

- become a member of the Register Committee of the Heritage Council for the discussion including the decision as to whether or not this place should be entered in the Register.
- will be asked as part of the discussion to present the views of your local government on the value of entering the place in the Register.
- are invited to participate fully in the discussion about the entry of the place in the Register of Heritage Places.
- are entitled to vote on whether or not the place in question should be entered in the Register.

Please note that the decision on whether or not to enter a place in the Register is made solely on the basis of whether or not the place has sufficient cultural heritage to warrant the protection of the *Heritage of Western Australia Act 1990*.

Confidentiality agreement: as an invited participant we ask you to remember that all discussions and decisions of the Register Committee of the Heritage Council remain confidential to the meeting until such time as the Minister has had the opportunity to consider any recommendation from the Council. Should you have any queries relating to these confidentiality provisions, please speak to one of the Heritage Council officers at the meeting or call the Manager, Assessments & Registration on 6552 4000.



HERITAGE COUNCIL
STATE HERITAGE OFFICE

HCWA CURTLAGE MAP P762-B HOLY TRINITY CHURCH, NORSEMAN

MAP 1 OF 2 PREPARED BY SERHIARD KLINGEBEIN (SENIOR LAND INFORMATION OFFICER), 18/08/2015

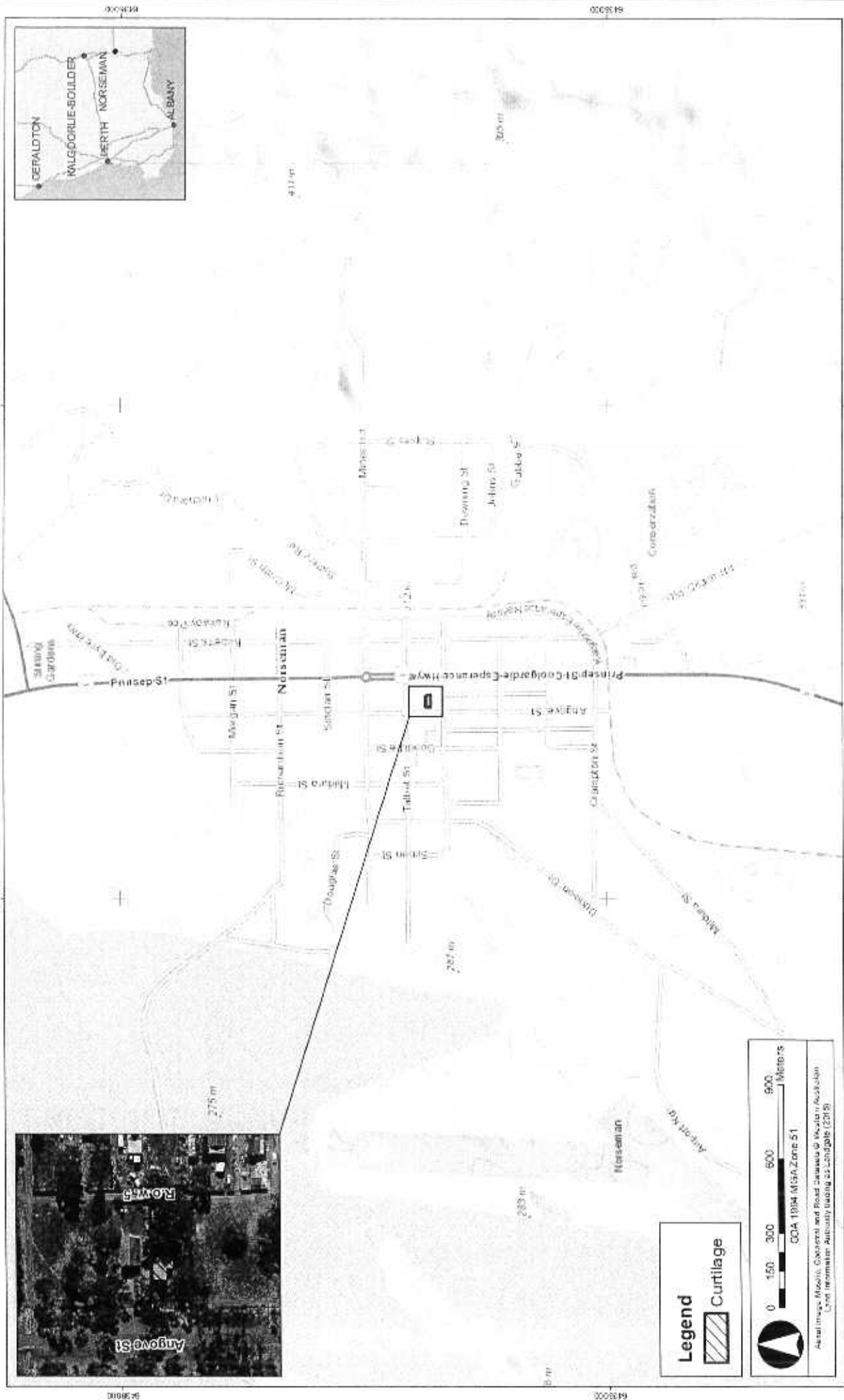

Legend

- Curtilage

0 150 300 600 900 Meters

CCO 10/04 M5A/Zone 51

Aerial images, Models, Contours, and Road Data are © Vector Australia
Cartographic Authority using 2010 imagery (2010)

38000

38000

38000

38000



HERITAGE COUNCIL
STATE HERITAGE OFFICE

HCWA CURTLAGE MAP P762-B HOLY TRINITY CHURCH, NORSEMAN

MAP 2 OF 2 PREPARED BY BERNHARD KLINGESEN (SENIOR LAND INFORMATION OFFICER) 18/06/2015



Legend

- Curtilage
- Cadastre

0 5 10 20 Meters

©DA 1994 M/GA Zone 51

Aerial Image Mosaic, Cadastre and Road Datasets © Western Australian Land Information Authority (using 30 Longitude (GCRS))

Row 5

P722908 34

Angove St



HERITAGE COUNCIL
STATE HERITAGE OFFICE

HCWA ZONES OF SIGNIFICANCE P762-B HOLY TRINITY CHURCH, NORSEMAN

PREPARED BY BERNHARD KLINGBEISEN (SENIOR LAND INFORMATION OFFICER) 19/06/2015



Legend

- Primary
- Secondary
- Intrusive
- Cadastre

0 2.5 5 10 Meters

GDA 1994 MGA Zone 51

Aerial Image, Maps, Cultural and Road Database & Western Australia Land Information Authority Ready as Lantige (2015)

384780 384780 384780

384780 384780 384780

384780 384780 384780

384780 384780 384780

384780 384780 384780

384780 384780 384780

384780 384780 384780

384780 384780 384780

**DOCUMENTATION OF PLACES
FOR ENTRY IN THE
REGISTER OF HERITAGE PLACES**

1. **DATA BASE No.** P762
2. **NAME** Holy Trinity Church, Norseman (1898)
FORMER NAME (or OTHER NAMES)
3. **LOCATION** 100 Angove Street, Norseman
4. **DESCRIPTION OF PLACE INCLUDED IN THIS ENTRY**
Lot 34 on Deposited Plan 222908 being the whole of the land in Certificate of Title Volume 85 Folio 91
5. **LOCAL GOVERNMENT AREA** Shire of Dundas
6. **OWNER AT INTERIM REGISTRATION**
Perth Diocesan Trustees
7. **HERITAGE LISTINGS**

Register of Heritage Places:	
National Trust Classification:	
Town Planning Scheme:	
Municipal Inventory:	11/6/2012
Register of the National Estate:	
8. **ORDERS UNDER SECTION 38 OR 59 OF THE ACT**

9. **HERITAGE AGREEMENT**

10. **STATEMENT OF SIGNIFICANCE**

Holy Trinity Church, Norseman, comprising a small timber framed and corrugated iron clad Church (1898) and associated outbuildings, has cultural heritage significance for the following reasons:

the place demonstrates the growth and development of the Anglican Church in Western Australia, particularly in the faith of small rural communities, the pressures on the Diocese of Perth to service the spiritual needs of the expanding goldfields, and is a rare intact example of an Anglican Church in the goldfields;

the place is a good example of Federation Carpenter Gothic architecture, and is a very rare example of an early metal-clad church in this style representing the early establishment phase of a regional parish;

11. ASSESSMENT OF CULTURAL HERITAGE SIGNIFICANCE

The criteria adopted by the Heritage Council in November 1996 have been used to determine the cultural heritage significance of the place.

PRINCIPAL AUSTRALIAN HISTORIC THEME(S)

4.5	Making settlement to serve rural Australia
8.6.4	Making places for worship

HERITAGE COUNCIL OF WESTERN AUSTRALIA THEME(S)

107	Settlements
111	Depression and boom
406	Religion
602	Early settlers

11. 1 AESTHETIC VALUE*

Holy Trinity Church, Norseman is a good example of Federation Carpenter Gothic architecture that demonstrates church aesthetics while responding to the design problems of limited funding and local material shortage. (Criterion 1.2)

Holy Trinity Church, Norseman is a landmark on Angove Street due to its identifiable ecclesiastical style and prominent presence in a relatively undeveloped street. (Criterion 1.3)

11. 2. HISTORIC VALUE

Holy Trinity Church, Norseman demonstrates the expansion of the Anglican Church during the Gold Boom in response to the dramatic population growth in this region and the need for pastoral services in the growing communities. (Criterion 2.1)

Holy Trinity Church, Norseman demonstrates the dramatic population growth of small goldfields settlements during the period 1890-1915, and the subsequent decline of many of these settlements due to changing economic conditions. (Criterion 2.2)

Holy Trinity Church, Norseman demonstrates construction of a church that responded to the challenges of the transport and availability of construction materials. (Criterion 2.4)

11. 3. SCIENTIFIC VALUE

* For consistency, all references to architectural style are taken from Apperly, R., Irving, R., Reynolds, P. *A Pictorial Guide to Identifying Australian Architecture. Styles and Terms from 1788 to the Present*, Angus and Robertson, North Ryde, 1989.

For consistency, all references to garden and landscape types and styles are taken from Ramsay, J. *Parks, Gardens and Special Trees: A Classification and Assessment Method for the Register of the National Estate*, Australian Government Publishing Service, Canberra, 1991, with additional reference to Richards, O. *Theoretical Framework for Designed Landscapes in WA*, unpublished report, 1997.

13. SUPPORTING EVIDENCE

The documentation for this place is based on the Conservation Plan completed on behalf of the Holy Trinity Church community in Norseman by Alice Steedman and Michael Ipkendanz, with amendments and additions by the State Heritage Office and the Register Committee.

13. 1 DOCUMENTARY EVIDENCE

Holy Trinity Church, Norseman, a small Anglican Church with associated outbuildings (garage and external toilet) at Norseman, was constructed in 1898 to provide a place of worship for the local Anglican community. The place is reflective of both the growth of small mining settlements and the development of the Anglican Church in Western Australia.

The interior region along Western Australia's southern coast was not settled until 1860s and 1870s, and development in this area was restricted to a handful of leases used as watering stations for pastoralists based in Albany.¹ Settlement of the area increased after pastoralist William Moir discovered gold in 1890, with subsequent finds leading to the declaration of the Dundas goldfield and the survey of the Dundas townsite in 1893.² The Norseman area (named after prospector Laurie Sinclair's horse) saw a township develop beside Lake Cowan in 1895, which over the next 5 years included the establishment of a racecourse, newspaper, water condensing plant, hospital and P767 Norseman Post Office.³ The municipality of Norseman was declared in 1896 and by the following year the population of the Dundas district amounted to 1,341 people, including 320 people in the Norseman townsite.⁴

Another aspect of Norseman's growth was the establishment of religious services. A church was a significant social institution in the development of small towns, the faith binding the community in rites of passage such as births, marriages and death, as well as general community events.

The Anglican Church had been the dominant faith at the foundation of the Swan River Colony in 1829, with Anglican services performed by Captain Irwin in place of an ordained minister. From 1829-1837 a temporary 'Rush Church' was established in Perth by visiting Archdeacon Thomas Hobbes, although the first Colonial Chaplain was Reverend John Wittenoom. The *Old Perth Court House* (P1948), a more substantial building, acted as a place of worship from 1837 until the first dedicated church was completed as St George's Church in 1845.⁵

1 Steedman, A, Ipkendanz, M, *Holy Trinity Church 98-100 Angrove Street Norseman*, The Perth Diocesan Trustees trading as the Anglican Diocese of Perth, 2014, p. 7;

2 *ibid.*; Peterson, E, *Our First Ten Years: Norseman 1894-1904*, private publication, 1994, pp. 5-7; 'Mining Intelligence', *The West Australian*, 27 September 1892, p. 6; 'The Goldfields', *The Daily News*, 13 October 1893, p. 3

3 Steedman & Ipkendanz, *op cit.*, p. 7; 'Turf Notes', *The Norseman Pioneer*, 1897, p. 10; 'The Norseman Hospital', *The Norseman Pioneer*, 6 March 1897, p. 4; 'The Premier's Trip', *Western Mail*, 27 May 1898, p. 28; see also assessment documentation for P767 Norseman Post Office

4 Steedman & Ipkendanz, *op cit.*, p. 7; 'Dundas District Census', *The West Australian*, 20 November 1897, p. 5

5 A E Williams, *West Anglican Way*, Province of Western Australia of the Anglican Church of Australia, 1989, pp. 30-46; The site of the original St George's church was between Hay Street and St Georges Terrace, northwest of P2102 *St George's Cathedral* (RHP)

Bishop Riley made constant visits to outlying parishes during this period, including pastoral tours of the state's interior in 1895 and 1896.¹⁵ When visiting Norseman in March 1896 the bishop performed the service in the dining room of Flanagan's Hotel, and it was reported that:

He is anxious that a suitable building would be speedily erected on the land given by the government for the purpose, and will then do his best to send a clergyman to labour on the fields. He pointed out the difficulty of obtaining suitable men for the newly formed towns on the goldfields.¹⁶

The early services of the Anglican Church at Norseman were conducted in January 1896 by Dr Elphick, who was a medical professional, member of the Norseman Progress League and also a licenced Diocesan layreader.¹⁷ Dr Elphick performed services in his tent, which included taking a collection in aid of a permanent church building.¹⁸ In February 1896 the government granted lots 33 and 34 in Norseman for the building of an Anglican church and Dr Elphick organised a building committee, with the intention:

to erect a structure of hessian, and to be content for the time with things "in the rough" rather than incur debt.¹⁹

This early church was completed in May 1896 under the direction of Dr Elphick, and a photo from that year shows a whitewashed hessian structure with the traditional steep pitched profile, covered by a cloth tent roof stretched out on a timber frame.²⁰ Reverend Livingston was assigned to the small congregation in 1897, having arrived in Western Australia from England, and while he possessed a common touch he found it hard to live on the stipend that the parish afforded him.²¹

The small parish organised itself to erect a more permanent structure in 1897, and the prospect was raised to ask the local Catholic congregation if Rev Livingston could use their building rather than the 'remnants of a very disreputable tent in which to conduct the services of his church'.²² The church services were transferred to the 'Krakouer Bros. Royal Hall,' Rev Livingston himself describing the situation:

We are outcasts, our tent church being blown to pieces, but like so many outcasts we have found refuge in a public house, and Mr. Krakouer, the inn-keeper, has allowed us, at a tiny cost, his fine hall for Sunday services.²³

15 *The Daily News*, 9 March 1895, p. 1; *The West Australian*, 31 January 1896, p. 4; *The West Australian*, 14 February 1896, p. 4; *The West Australian*, 13 March 1896, p. 4; *The Daily News*, 28 August 1896, p. 2

16 *Norseman Esperance Guardian and Dundas Goldfields Advertiser*, 14 March 1896, pp. 4, 9

17 Steedman & Ipkendanz, *op cit.*, p. 9; 'Norseman Progress League', *Norseman Esperance Guardian and Dundas Goldfields Advertiser*, 25 January 1896, p. 4; *Norseman Esperance Guardian and Dundas Goldfields Advertiser*, 8 February 1896, p. 3

18 Steedman & Ipkendanz, *op cit.*, p. 9; *Norseman Esperance Guardian and Dundas Goldfields Advertiser*, 18 January 1896, p. 3

19 *Norseman Esperance Guardian and Dundas Goldfields Advertiser*, 22 February 1896, p. 6

20 *The West Australian*, 5 June 1896, p. 4; *First Anglican Church, Norseman 1896*, Battye Library 6333B, in Steedman & Ipkendanz, *op cit.*, p. 9

21 'Anglican Synod', *The West Australian*, 7 December 1897, p. 7; *West Australian Sunday Times*, 19 December 1897, p. 14; *Norseman Times*, 13 April 1898, p. 2; Steedman & Ipkendanz, *op cit.*, p. 10

22 'Church News', *The Daily News*, 12 June 1897, p. 6; 'Union of churches', *Norseman Times*, 15 January 1898, p. 2

23 'The Anglican Church', *Norseman Times*, 25 May 1898, p. 3;

architectural character.³⁵ The closure of the Norseman Gold Mines company in 1908 marked the beginning of a decline in the small town, with miners moving on as mineral resources were depleted or remaining reefs found to be overestimated.³⁶

By the interwar period, Norseman had lost more of its workforce due to the First World War.³⁷ Despite the improvement in water facilities the shortage of water was still an ongoing problem, with miners being laid off when water supplies ran low.³⁸ This problem was largely alleviated in 1936 with the opening of the Norseman to Coolgardie portion of the Mundaring to Kalgoorlie water pipeline.³⁹ The population of Norseman continued to wane during the 1920s due to poor economic conditions, however the arrival of the Western Mining Corporation at Norseman in 1935 saw a re-invigoration of mining operations and new development in the town.⁴⁰

The Anglican Church responded to the times by ministering to soldiers and their families, securing additional funds from England to minister to the new settlers, and encouraging more clergy to visit remote areas. This raised the number of priests from 13 in 1904 to 31 by 1929. The church also prioritised education in the interwar period, receiving support from the Sisters of the Order of Elizabeth of Hungary (known as the 'Grey Sisters'), who were particularly active in children's education.⁴¹

The Anglican ministry at Norseman held a number of fundraising events, including those for donations for the Returned Servicemen Association, as well as holding services for soldiers.⁴² The church also performed its traditional role in officiating weddings, funerals and hosting visiting clergy from Perth.⁴³

Norseman's fortunes fluctuated through the post-war period, with gold mining and pastoralism waning but iron ore and nickel mines expanding. This expansion saw new infrastructure growth in the building of a junior high school, a swimming pool, telecommunications and road improvements, as well as an increase in population represented by mining company housing.⁴⁴ Norseman also diversified its economy by investing in tourism after 1960.⁴⁵

35 'Norseman Revisited', *Sunday Times*, 21 February 1909, p. 3

36 Hocking Planning and Architecture *op cit.*, 1995, p. 13; Steedman & Ipkendanz, *op cit.*, p. 7; *The West Australian*, 1 January 1901, p. 8; *Western Mail*, 24 April 1909, p. 34; *Kalgoorlie Miner*, 5 August 1909, p. 5

37 'Norseman Recruits', *Kalgoorlie Miner* 20 March 1915, p. 8; 'Norseman Recruits', *Western Argus*, 2 January 1917, p. 10

38 *Western Mail*, 11 March 1911, p. 19; Hocking Planning and Architecture *op cit.*, 1995, p. 13

39 Hocking Planning and Architecture *op cit.*, 1995, p. 13

40 *Ibid.*, pp. 14-16

41 Thelfall *op cit.*, pp. 38-44; Williams, *op cit.*, pp. 234-236; 'Needs of Today', *The West Australian*, 18 November 1942, p. 2; 'Anglican Synod', *The Bunbury Herald and Blackwood Express*, 12 September 1922, p. 1

42 'ANZAC Day Celebrations', *Kalgoorlie Miner*, 1 May 1919, p. 2; *Western Argus*, 6 May 1924, p. 7; *Western Argus*, 21 October 1924, p. 16; *Western Argus*, 11 May 1920, p. 10; 'Norseman Efforts', *The West Australian*, 7 March 1946, p. 9

43 *Western Argus.*, 10 December 1918, p. 34; *Western Argus*, 6 May 1924, p. 7; 'Norseman Tragedy', *Kalgoorlie Miner*, 27 February 1939, p. 4

44 Hocking Planning and Architecture *op cit.*, 1995, pp. 17-19

45 *Ibid.*, pp. 18-19

Holy Trinity Church, Norseman

Exterior

Holy Trinity Church, Norseman comprises a rectangular main hall, with a small porch extending 2 metres out from the eastern face and a southeast hall extension to the rear that functions as the vestry. The buildings are timber frame construction, clad in standard orb corrugated iron with a corrugated iron roof.⁵⁵

The western-facing porch features entrance doors to the north and south although only the northern door is used. There was a timber step leading into the main door, which has since collapsed. Inside, the porch is carpeted and the timber framing is apparent. The entrance to the hall does not have a door, providing open access.⁵⁶

The porch and hall feature timber framed, pointed-arch windows on the northern, southern and western faces, each sash divided into three sections, with a mix of transparent and obscure glass types. The lower sashes are pivot-hung but are no longer operational.⁵⁷

The vestry has its own entrance door on the southern face with a small concrete step leading up to a timber door frame. The windows are metal framed louvre windows to the east and west and sliding sash windows to the south.⁵⁸

The roof of Holy Trinity Church, Norseman appears to have been replaced in recent years, currently constructed of single length galvanised sheeting with a rolled-top galvanised profile. The gutters are squareline in profile with rectangular gutters. Bargeboards are present although only the north-eastern corner retains original detailing.⁵⁹

The roof is gabled, the western gable to the hall featuring a rectangular ventilator and a timber pendant and finial that is topped by a cross. The gable above the porch features a similar finial/pendant combination, and discolouration near the top of the finial suggests that this too was originally a cross. The eastern gable at the rear of the church features another rectangular ventilator. The roof of the vestry exhibits a skillion roof that extends directly from the main roof.⁶⁰

The exterior of the Holy Trinity Church, Norseman is painted a light cream with teal highlights around the door and window frames, however all window frames are showing signs of decay. Replacement timber barge capping also exhibits signs of decay.⁶¹

The sub-structure of the building appears to be bush poles, with the floors raised above ground level. An area has been cleared at the rear of the church to allow for sub-floor ventilation. There does not appear to be any drainage system (e.g.

55 *ibid.*, p. 18

56 *ibid.*, p. 18

57 *ibid.*, p. 18

58 *ibid.*, p. 18

59 *ibid.*, p. 18

60 *ibid.*, p. 18

61 *ibid.*, p. 18

Other

Behind Holy Trinity Church, Norseman is a small corrugated iron garage. Behind the Rectory is a small shed. There is also a toilet on Lot 34, detached from the main structures and located towards the eastern end of the lots.⁶⁹

A number of mature trees and shrubs exist on Lot 34.⁷⁰

13. 3 COMPARATIVE INFORMATION

Anglican Church

A search of the State Heritage Office database for Anglican Churches constructed between 1890-1915 returns 113 places, 31 of which are entered in the RHP. By restricting this number to regional churches the figure is reduced to 80 places, of which 23 are entered in the RHP. The places comparable to Holy Trinity Church, Norseman as demonstrating the regional expansion of the Anglican Church during the Gold Boom period include:

- P150 *St Marys Anglican Church Precinct, Beverley* (RHP): comprising a stone church (1892), rectory (1889), parish hall (1957) and lychgate (1956). The place represents the growth of the parish of Beverley following the arrival of the railway in 1886, and the growth of the region following the construction of the Great Southern Railway in 1889.
- P1329 *St Andrew's Church and Hall* (RHP): a brick and concrete church (1898) and hall (1911), the place includes the oldest church in Katanning, which was part of the initial establishment of the Katanning townsite following the construction of the railway line. The place is associated with Frederick Piesse, who was influential in the development of Katanning.
- P1909 *Holy Trinity Anglican Church, Northampton* (RHP): a course rubble weathered granite church in the Federation Gothic Revival style (1908), the place is a landmark within the town of Northampton and a fine example of its style. The place demonstrates the rise to prosperity of Northampton and the importance of religion in the local community.
- P2332 *Holy Trinity Anglican Church* (RHP): a single-storey stone church in a vernacular style with Victorian Romanesque elements. Constructed in 1895, the building is the oldest church in the Pilbara and reflects the continuous presence of the Anglican Church in the region. The place reflects the nineteenth century development of Roebourne and the role of religion in that development.

Of these 80 regional Anglican churches constructed 1890-1915, 3 were located in the Goldfields region:

- P206 *St Matthew's Anglican Church & Hall*: constructed in 1906 at Boulder, this Anglican church was constructed in the Federation Carpenter Gothic style. The place is in the HCWA Assessment Program.

⁶⁹ *ibid.*, p. 19

⁷⁰ *ibid.*, p. 19

- P297 *Anglican Church of the Annunciation* (RHP): a timber framed, Federation Carpenter Gothic style church (1903) that is considered a fine example of the style. The place was the centre for the North West Diocese 1910-1964 and is associated with a number of Anglican Bishops.
- P436 *St John's Anglican Church, Capel* (RHP): a single storey timber church (1924) considered to be a fine example of the Federation Carpenter Gothic style. The place and its internal fittings are also considered fine example of the work by architects Eales & Cohen, and is associated with the Anglican Church.
- P2356 *Black Range Church* (RHP): a timber-framed, corrugated iron-clad church that is considered a rare example of a church internally lined with pressed metal. The place was constructed in Sandstone in 1903 following the discovery of gold in the area and functioned as a Catholic parish until the 1970s.
- P2548 *St Peter's Church* (RHP): a small one room timber building constructed in 1910, the place and its fittings is considered an important example of the Federation Carpenter Gothic style with a high degree of integrity and authenticity. The place is considered a landmark in the Pindellup district.
- P14403 *Methodist Church (fmr), Denmark* (RHP): a single storey weatherboard and corrugated iron church, the place is considered a good representative example of the Federation Carpenter Gothic style. The place was constructed by the Methodist Church in 1925 and used until 1982.

The exterior cladding of *Holy Trinity Church, Norseman* demonstrates the difficulties in obtaining and transporting construction materials into the goldfields during the Gold Boom period. A search of the State Heritage Office database for churches built during this period using corrugated iron as a cladding material returns 153 places, of which 43 are entered in the RHP.

A search of the State Heritage Office database for Federation Carpenter Gothic buildings using corrugated iron as a construction material returns 141 places, however the number of places using corrugated iron as the internal wall cladding is difficult to determine, as this information is not always expressed in the database. It is known that the following churches use metal interior walls:

- P1529 *Presbyterian Church, Meekatharra* (RHP)
- P2356 *Black Range Church* (RHP)

A search of the State Heritage Office database for Gold Boom era churches clad in corrugated iron was also attempted, as such simple, corrugated iron clad structures represent the initial thrust of goldfields settlement and construction. However, the current format of the State Heritage Office database does not allow for this level of construction detail.

Growth and Decline of Mining Settlements

A search of the State Heritage Office database for examples of goldfields places that represent the growth and decline of mining settlements is difficult to accurately extract from the State Heritage Office database. However, a search for places within the goldfields and wheatbelt regions with the associated stated

Holy Trinity Church, Norseman appears uncommon as an example of a goldfields place demonstrating the theme of Depression and boom, however there are a number of other examples, including townsites and one other church, which have not yet been considered for the State Register, or that have not yet been entered in the State Heritage Office database.

13. 4 KEY REFERENCES

Steedman, A, Ipkendanz, M, *Holy Trinity Church 98-100 Angove Street Norseman*, The Perth Diocesan Trustees trading as the Anglican Diocese of Perth, 2014.

13. 5 FURTHER RESEARCH



10.3.1

Change in Electoral Boundaries

6 August, 2015

Dundas Shire Council
C/O Chief Executive Officer
Shire of Dundas
PO Box 163
NORSEMAN WA 6443



Dear councillors

PROPOSED ELECTORAL BOUNDARY CHANGES

As you may be aware, the Western Australian Electoral Distribution Commissioners recently proposed new and amended boundaries for many of the electorates across the State.

Under the proposed changes, the Legislative Assembly electorate of Eyre would be split between Wagin (to be renamed Roe) and Kalgoorlie, with towns such as Esperance, Hopetoun and Ravensthorpe falling into the Roe electorate.

The abolition of Eyre would result in the number of country seats dropping to 16, with the number of city seats increasing to 43.

As Member for the Mining and Pastoral Region, I am extremely disappointed and concerned by the proposal to abolish the Eyre electorate as I believe it would diminish the voice of the Esperance and south-east region.

Realistically, it is difficult to see how south-east communities could be adequately represented in a reconstituted and enlarged Roe electorate. The Esperance/south-east region is unique and does not fit well politically or economically with the Wheatbelt.

Furthermore, I believe these proposals risk fragmenting the existing economic, people-to-people, services and governmental links between Esperance/the south-east and the Goldfields.

It is my view that there needs to be more consideration of existing synergies when deciding electoral boundaries.

State-wide, abolishing Eyre in favour a new seat in the Perth metropolitan area would only further marginalise country people and strengthen the dominance of city-centric parties and politicians.

The Nationals WA made a submission to the WA Electoral Commission that would have allowed the Electoral Commissioners to meet the requirements of the Act that involved minimal change. Unfortunately, this advice was ignored.

I will be lodging a written objection to the proposal to abolish Eyre. I encourage all Eyre residents to look at the proposed boundary changes and make their views known to the WA Electoral Commission.



The proposed boundaries can be viewed online at
<http://www.boundaries.wa.gov.au/have-your-say/2015-proposed-boundaries-and-reason>

Written comments and objections should be emailed to boundaries@waec.wa.gov.au before 5pm on August 24, 2015.

If you would like assistance in writing and lodging an objection, please do not hesitate to contact my electorate office in Esperance on 1800 622 161.

As always, my office is ready to assist you with any State issue or enquiry and I am committed to serving as a strong advocate for the region.

Yours sincerely

A handwritten signature in black ink, appearing to read 'DG', is positioned above the typed name.

**HON DAVE GRILLS MLC
MEMBER FOR THE MINING AND PASTORAL REGION**

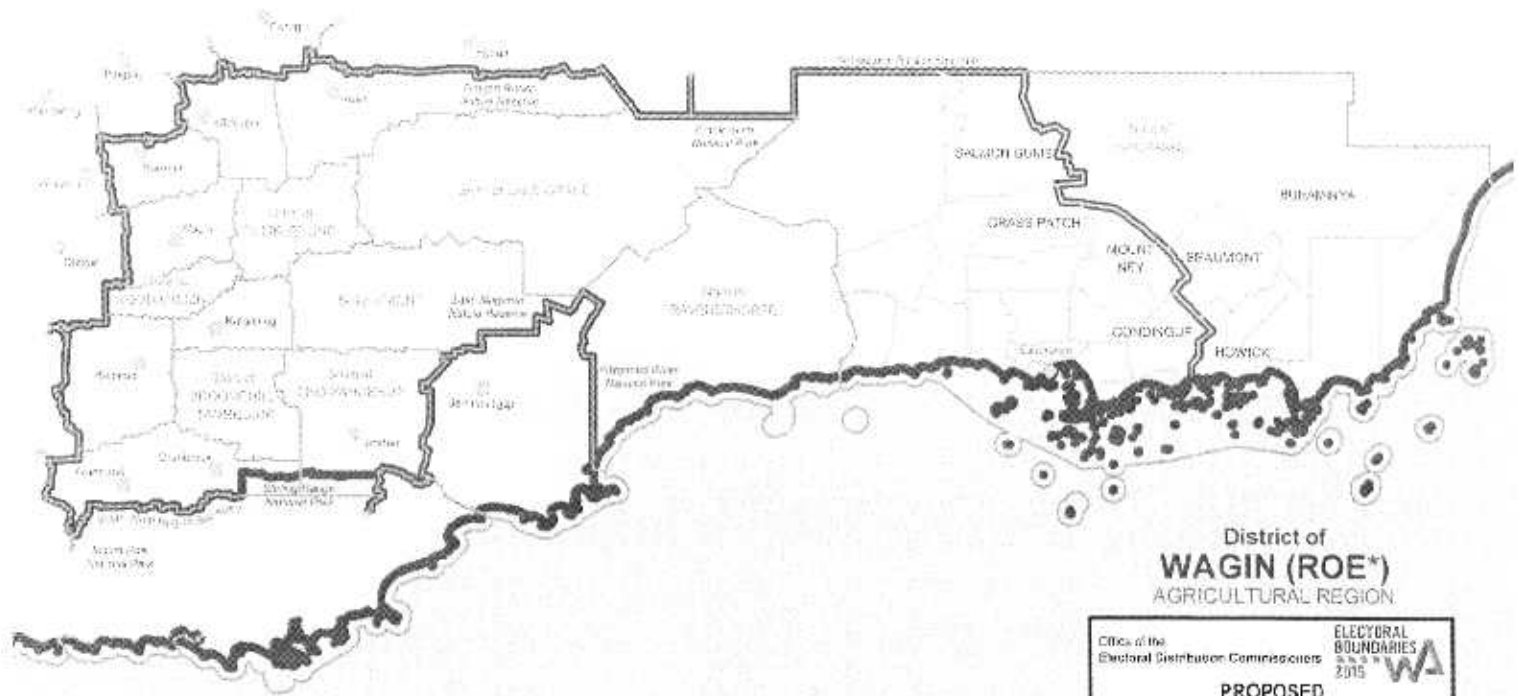

District of
WAGIN (ROE*)
 AGRICULTURAL REGION

Office of the Electoral Distribution Commissioner

ELECTORAL BOUNDARIES 2015 WA

PROPOSED ELECTORAL BOUNDARIES

- District boundary
- Local government boundary/name
- Locality boundary/name
- Reserve





*Proposed name change

District of NORTH WEST CENTRAL MINING & PASTORAL REGION

Office of the
Electoral Distribution Commissioner

ELECTORAL BOUNDARIES
2015 WA

**PROPOSED
ELECTORAL BOUNDARIES**

-  District boundary
-  Local government boundary/name
-  Locality boundary/name
-  Reserve

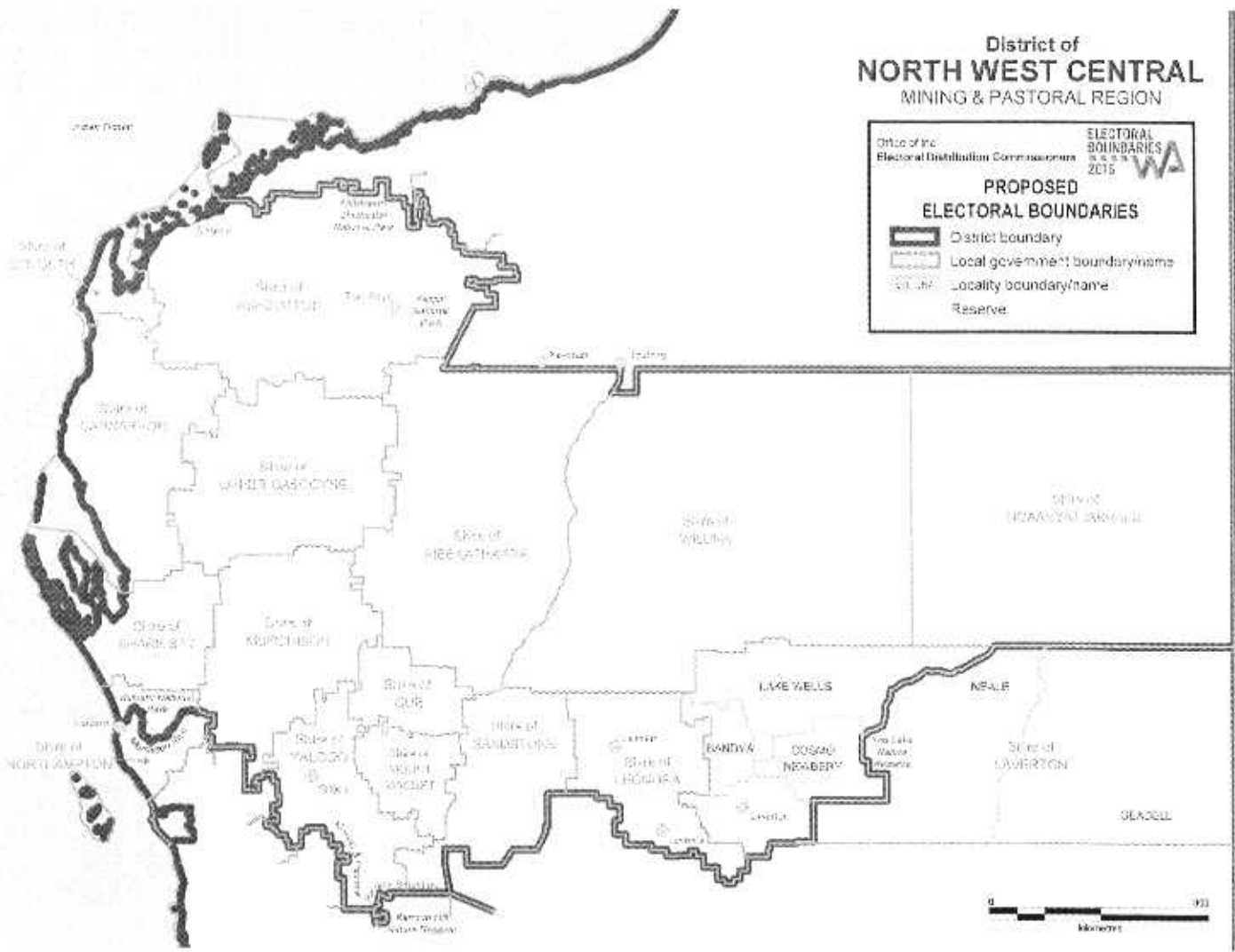

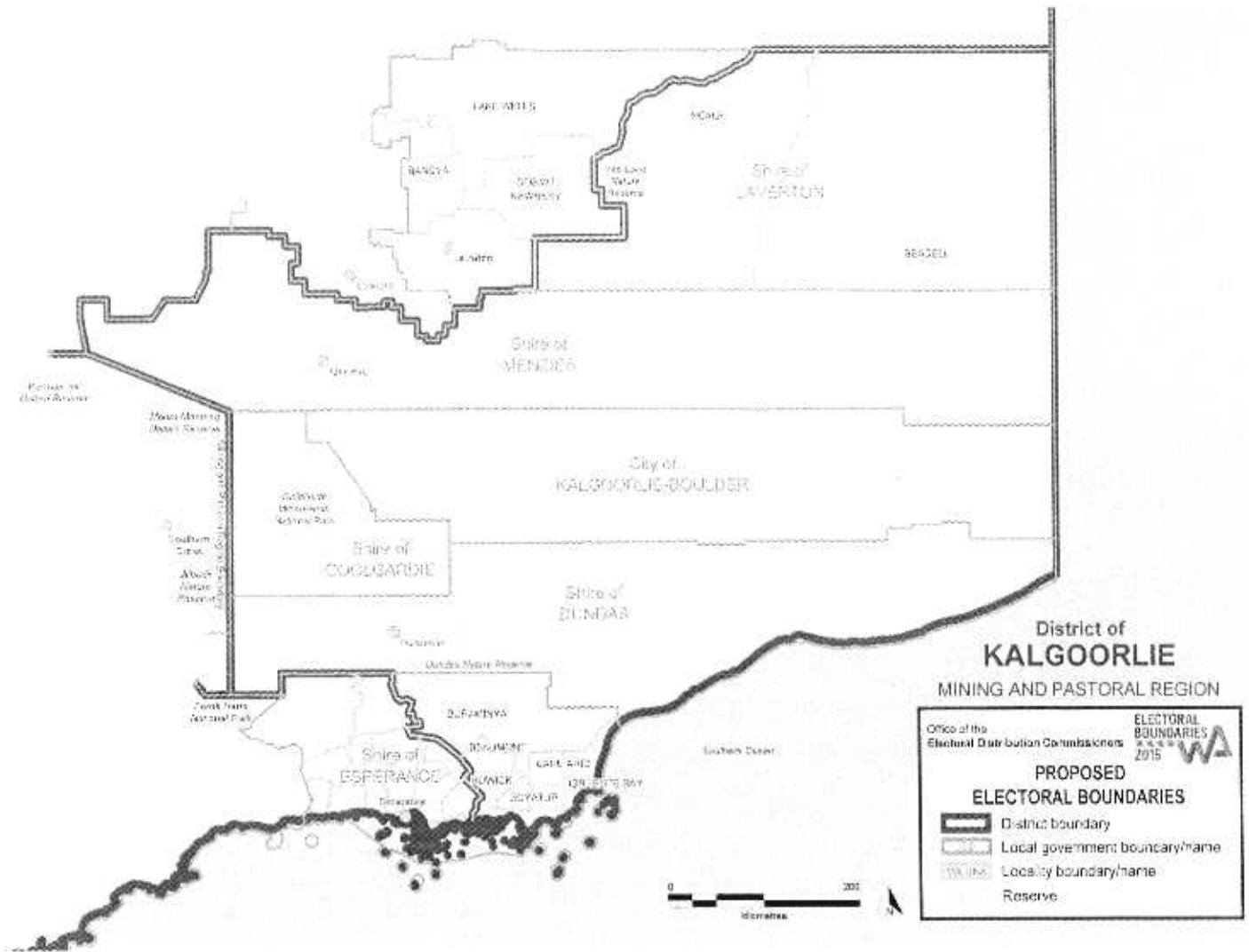



10.3.2

MOU Kalgoorlie Boulder Visitor Centre

RECEIVED
21 JUL 2015



Memorandum of Understanding 2015

Kalgoorlie Boulder Visitors Centre & Shire of Dundas

Kalgoorlie Boulder Visitor Centre
316 Hannan Street, Kalgoorlie
PO Box 10161 WA 6430
(08) 9021 1966

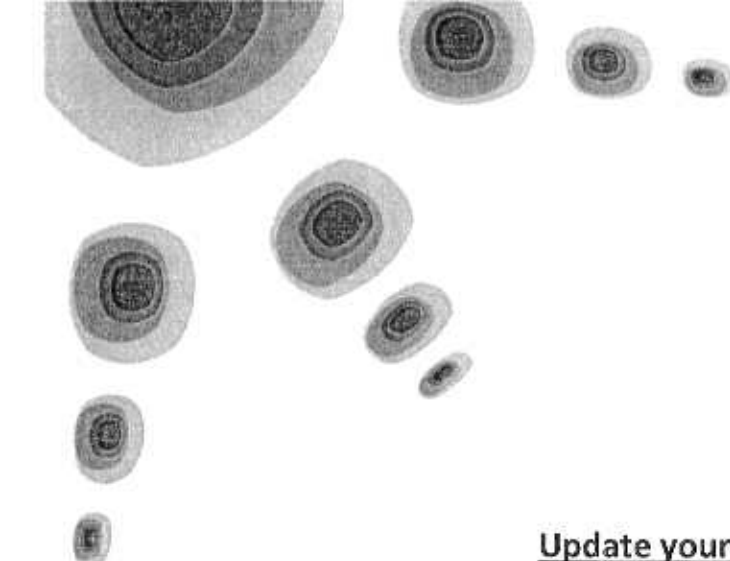

Update your Information:

Organisations Name: _____

Contact Person: _____

Address: _____

Phone: _____

Email: _____

This Document will cover the Following:

- ✓ Memorandum of Understanding Agreement Objective
- ✓ Validity of Agreement
- ✓ Principles of Agreement

- ✓ Memorandum of Understanding Agreement Objective

To produce a memorandum of understanding that will bind together Kalgoorlie Boulder Pure Gold Visitor Centre and Shire of Dundas in a lasting professional relationship of cooperation that will best promote Kalgoorlie-Boulder and the surrounding regions and provide the highest possible standards of service to both the regional tourism industry and the visiting public.

- ✓ Validity of agreement

This Memorandum of Understanding is valid for 2 years from the 1st of July 2015 and is subject to revision at the end of that time.



✓ Principle of Agreement

Kalgoorlie Boulder Visitors Centre will:	Reciprocal Member will:
- Endeavour to treat all reciprocal partners as a member of the Visitor Centre.	Recognise the KBPG as a key stakeholder in tourism related issues in the region.
Showcase 1X DL brochure in the display area at KBPG.	- Promote the KBPG in any relevant promotional activities.
- Allow partners to advertise in the Holiday Planner at a discounted rate.	- Assist with accurate information for the annual Kalgoorlie-Boulder holiday planner.
- A4 industry listing with business name, phone & Address.	- Display and distribute the Kalgoorlie-Boulder holiday planner where appropriate.
- Advertise your employment vacancies on our website with a direct link to you.	- Provide up to date information on any new products/events or initiatives that are relevant to tourism in the region.
- Send you a regular e-newsletter.	- Respond promptly to requests for information and assistance.
- Give an opportunity for inclusion in cooperative marketing and promotional activities.	- Maximising opportunities and benefits the will help with the flow to our community.
- Offer discounted rates for industry functions, seminars and workshops.	- Create a lasting community legacy for the region.
- Give you voting rights at the KBVC Inc. AGM	- Maximise positive outcomes at a local level.
- Give you eligibility to be nominated onto the KBVC Inc. Board.	- Focus on areas where there are joint benefits to be achieved.

The above Memorandum of understanding is between

Kalgoorlie Boulder Pure Gold and _____

Name: Angeleen Schimanski

Name: _____

Title: General Manager

Title: _____

Signed: 

Signed: _____

Please sign and return to the address outlined on page 1.



10.3.3

RV Friendly Town

RV Friendly Town™ Assessment Form

Outline of Proposed RV Friendly Town™

1. This document is confidential when completed. Information contained herein will be used for initial assessment by the Campervan & Motorhome Club of Australia Limited (CMCA). More in-depth details may be required to complete the process.
2. The designation as an RV Friendly Town™ refers to a town that is friendly toward all travellers in recreational vehicles, where large and small vehicles have equal access to town facilities such as parking, a dump point and potable water.
3. Vehicle combinations can range from 5 metres to 19.5 metres in length.
4. RV refers to all recreational vehicles. This includes motorhomes, caravans, campervans and camper trailers. This does not include tent camping.
5. Completion of this document does not commit CMCA to designating the above mentioned town as an RV Friendly Town™.

RV Friendly Town™

Name of Town: NORSEMAN WA

Name of City/Council/Shire offices: Shire of Dundas

Address: 88/92 Prinsep St, Norseman WA 6443

Contact's name: Richard Brookes Position: CEO

Email: ceo@dundas.wa.gov.au

Phone: (08) 9039 1205 Fax: (08) 9039 1359

Website: http://www.dundas.wa.gov.au/ Date: August 2015

Address of Council depot (for delivery of signs): _____

Name of depot contact: _____ Phone: _____

Give a brief description of the town (e.g. wide tree lined streets; historic buildings; proximity to a river, lake etc.):

Norseman "the Eastern gate to the Western State" is a major stopping point for travellers to and from the East

Norseman is the major town in the Shire of Dundas and is situated 726 km from Perth. The Borders of the Shir

A visit to the website (www.dundas.wa.gov.au) and Facebook feature is an excellent resource for the traveller

Business mining and tourism are the backbone of the Norseman economy.



Give a brief history of the town and its main industries (e.g. established as a mining town, primary rural industries). Indicate any new or unusual initiatives undertaken by the local government or community:

The history of Norseman and Dundas begins in the 1840's with the exploration of the South Coast by Edward J n 1894 Laurie Sinclair, whilst prospecting about 4 miles north of Dundas, discovered a rich gold reef which he r Popular legend has it that after tethering his horse "NORSEMAN" up for the night, Laurie found a chunk of a gc

Recreational Vehicle Friendly Facilities

This section is essential for assessment. Please answer all questions carefully.

1. A self-contained recreational vehicle is one that has the ability to retain all waste within the confines of the vehicle, including black and grey water.
2. Parking bays for all sized recreational vehicles within a kilometre of the Post Office or Post Office Agency is highly desirable.
3. Low cost, short term overnight parking no more than 5 kilometres from the Post Office or Post Office Agency is considered an essential factor in the RV Friendly Town™ designation.
4. Longer term parking for a minimum of three days for self-contained vehicles is a desirable factor in the RV Friendly Town™ designation.
5. As the RV Friendly Town™ program may bring extra vehicles through the town, the local caravan park(s) will be encouraged to join the CMCA Friendly Caravan Park Listing. For an application form, please contact CMCA National Headquarters.
6. A dump point is essential for the safe disposal of black and grey water waste. If the town does not have a dump point, please refer to the CMCA Dump Point Subsidy program.
7. Potable water for refilling fresh water tanks is also essential.

In Town Casual Parking

Is there parking for all RV tourists within a kilometre of the Post Office or Post Office Agency?

(This parking needs to only be short term, e.g. long enough to allow for grocery shopping, and needs to be clearly sign posted as being for all recreational vehicles. It should read 'RV Parking Only' as opposed to 'Caravan Parking Only' or 'Motorhome Parking Only'. See size requirements below)

Yes No Address/Location: Roberts Street

Describe access (e.g. how to get there, if it is easy to find, if it is well sign posted, road condition): Generally there is little or no need

Access to the Norseman general business district and Visitor Centre is well sign posted, towing vehicles are pro

What size recreational vehicles can the area accommodate? <11 metres >11 metres

No. of vehicle units provided for: 30 mixed sizes

Are there parking limits? Yes No Hours: _____

Location of nearest public toilet? Roberts Street

Comments: Showers (small charge) and toilets are available at the Visitor Centre.

In Norseman there are two parks with public conveniences which also have grassed picnic areas with free BBQ

Short Term Parking

Is there provision for low cost, short term overnight stays, close to the CBD (24 hours+)? Yes No

Distance from town centre in kilometres: 1km (max)

Location/Name (as the locals know it): Sinclair Street Sports Complex

Latitude (mandatory): 32.196567 Longitude (mandatory): 121.1775886

Address (include nearest cross street): Sinclair St flows into the Sports Complex from the Junction of Princep St (main st

What size recreational vehicles can the area accommodate? (Allow for full turning circle if necessary, up to 35 metres for big rigs.)

<11 metres >11 metres

Facilities

Self-contained only

Yes No

Length of stay

24hrs 48hrs 72hrs 96hrs Other

Pets permitted

Yes No Conditional

Mobile phone service

Yes No

Parking permit required

Yes No **Cost:** Nil

Services

Showers Rubbish bins Toilets Covered seating
 Power BBQ Water

Long Term Parking (for self-contained vehicles)

Is there provision for longer term overnight stays? (e.g. bush camp, minimum of three nights.) Yes No

Distance from town centre in kilometres: _____

Location/Name (as the locals know it): _____

Latitude (mandatory): _____ Longitude (mandatory): _____

Address (include nearest cross street): _____

What size recreational vehicles can the area accommodate? (Allow for full turning circle if necessary, up to 35 metres for big rigs.)

<11 metres >11 metres

Facilities

Self-contained only

Yes No

Length of stay

24hrs 48hrs 72hrs 96hrs Other

Pets permitted

Yes No Conditional

Mobile phone service

Yes No

Parking permit required

Yes No **Cost:**

Services

Showers Rubbish bins Toilets Covered seating
 Power BBQ Water

Local Caravan Park

Address: N/A

Contact name: _____ Phone: _____

Is the caravan park willing to join the CMCA Friendly Caravan Park Listing? Yes No (See attached CMCA Caravan Park Listing Forms)

Water

Is potable water available? Yes No Location: Visitor Centre Roberts St.
Latitude (mandatory): 32.196131 Longitude (mandatory): 121.780649

Dump Point

Is a free dump point available close to town? Yes No
Location: Roberts St. (Free to CMCA members only) fee for non-members.
Latitude (mandatory): 32.196131 Longitude (mandatory): 121.780649

Is this dump point suitable for access by big rigs? Yes No

Access Restrictions (e.g. turning restrictions, height/weight restrictions, wheelchair access): _____

Size Restrictions (keep in mind that a 19.5m vehicle requires a 35m turning circle): Larger towing vehicles may have to unhitch the

<11 metres >11 metres

Tourist Information

1. Information about your town should be available at the Visitor Information Centre or equivalent.
2. Each RV Friendly Town™ is allocated a page on CMCA's website, featuring a link to the town's own website. This allows members to discover what is happening in the area.

Visitor Information Centre (VIC)

Name: Norseman Information Centre
Address: Welcome Park, Roberts St Norseman WA 6443
Postal address: _____
Phone: (08) 9039 1071 Fax: _____
Email: tourism@norseman.info
Website: www.norseman.info
Contact person: _____ Position: Centre Manager

Is there a document containing a town map showing the location of medical facilities, shopping areas and tourist attractions etc.? Yes No (if yes, please attach)

VIC Accessibility and Parking

What size recreational vehicles can the VIC car park accommodate?

<11 metres >11 metres

Other Services

Does the VIC provide other services such as bookings, conducted tours, internet for visitors, etc.? Yes No

If yes, please detail: The visitor centre is an agent for Transwa and can make bookings and issue tickets for all tr

Visitor Attractions

Please list any regular/annual/occasional visitor attractions the town has to offer: _____
There is no lack of opportunity to explore and enjoy out door activity in and around Norseman. Visitors have a
Please list the date of any regular events: Community Markets 3rd Saturday of the month.

Town Traders

Is there a supermarket? Yes No Phone: _____
Address: Roberts Street Norseman.

Medical Services

Is there a doctor's surgery? Yes No Phone: 08 9039 9235

Address: _____

Provide details of services available (surgery hours or special arrangements etc.): See attached Services document

Is there a hospital? Yes No Phone: 08 9039 9200

Address: Talbot St, Norseman

Is there a 24hr clinic? Yes No Phone: _____

Address: _____

If there are no 24hr medical facilities, please describe the emergency service for injured or ill patients (e.g. local ambulance vehicle based in the town):

Is there a pharmacy? Yes No Phone: _____

Address: See attached Services document

If no pharmacy, what procedure is in place to obtain pharmaceutical products? _____

Is there a dentist? Yes No Phone: _____

Address: See attached Services document

RV Friendly Town™ Agreements

1. CMCA publishes a monthly Club magazine, *The Wanderer*, which is distributed to over 66,000 members.
2. CMCA will publish a complimentary article based on information provided by council or an authorised tourism promotion person, to promote your RV Friendly Town™. You may use the article to promote the region, any upcoming significant events, etc.
3. If required, CMCA National Headquarters can provide contact details to obtain rates for regular advertising in *The Wanderer* and on the CMCA website.
4. Free listing on the CMCA website and an announcement on the CMCA Facebook page will be provided.
5. Each month a complimentary copy of *The Wanderer* will be sent to a designated location such as the VIC or council offices.
6. CMCA can provide various promotional signs for dump points, RV access and high impact RV Friendly Town™ signs.
7. Following this preliminary assessment, CMCA will contact the contact person listed on page one to finalise further details.

Article in *The Wanderer*

Will the council/tourism office supply editorial and photographs for one free feature article? Yes No

Would the council/tourism office want to place an advertisement in conjunction with the article? Yes No

Any additional comments: There are 7 eateries in Norseman located on Princep St or Roberts St, a Bottleshop/t

Two Service Stations; BP at the entrance to Town on the main highway and Caltex at the north end of Princep

RV Friendly Town™ Signage

RVFT signs can be erected or placed on an existing town welcome sign as per the examples below.

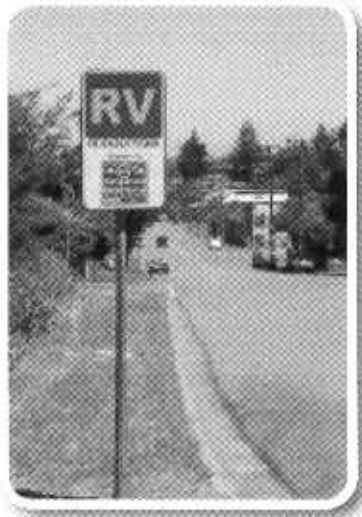

CMCA will supply two (2) RVFT signs free of charge. Additional signage is available for purchase at \$145.00 each, or two (2) for \$260.00.

Would the council like to order any extra signs? Yes No Quantity: _____

Or council may wish to have custom signage made as illustrated below.



Please return completed form to

PO Box 254 HRMC, NSW 2310

F: 02 4978 8799

E: memberbenefits@cmca.net.au

CMCA Office Use Only

Final recommendation: Yes No

Comments: Comments by Phil Chadd WAMST W28874. Norseman is a key link in the chain of WA RVFTs establi



10.3.4

Officers Reports

REPORT TO COUNCIL
ORDINARY MEETING TUESDAY 18TH AUGUST 2015

AREA: COMMUNITY DEVELOPMENT

OFFICER: PANIA TURNER

Period of Reporting: 18th July – 14th August 2015

Introduction:

It has been a busy 1st month into the CDO role which I am enjoying thoroughly. I have been able to get out and meet local community groups and as they come into town introduce myself to the visiting services that service our community.

Current Projects:

Norseman Arts Festival 2nd - 8th November 2015

Local advertising has now commenced.

Entry forms are in circulation.

Sponsorship & Supporters Confirmed:

Local: Norseman Hardware
Norseman Today
Norseman DHS P&C
Norseman Ladies Craft Group
Norseman Community Resource Centre
Norseman Visitors Centre
Norseman Men's Shed

Communications with entertainment, arts workshop providers and community arts projects are well underway, however I am waiting for confirmation and approval of a grant application before bookings can be made.

Community Development Committee (CDC).

The first meeting of the CDC was a good introduction with members going around the table to present their thoughts and expectations of what community development needs to take place within the Shire.

There was unanimous thought of the importance of the Shire facilitating the connection of like-minded people within the community.

From that I will be offering an Evening with Business. These will be relaxed semi-formal occasions for business owners, managers, service industry heads to gather with Shire Councillors, Management Staff and each other. The evenings will allow the opportunity for discussion and networking amongst the business community. There may be occasion where a guest speaker is invited to present on identified topics of interest or current practice. The evenings will provide light supper and refreshments.

Have a Chat morning teas. An opportunity for members of the public to come and have morning tea with the CEO, DCEO and selected councillors as available. Once again there may be the opportunity for guest presenters to come along.

I will be running these events on alternate months to each other so in effect we have a get together once a month.

Goldfields –Esperance Arts and Culture Framework 2015-2020

On Thursday 6th August I attended the launch of the Goldfields Arts and Culture Framework in Esperance. This vital framework and strategic plan has resulted from the collaborative efforts of the Regional Development Australia Goldfields Esperance (RDAGE) Country Arts WA, community consultations and creative business and talent from across the Region.

Priorities from the framework are:

1. Central Coordinating Hub.
2. Leadership Development and Skills Training.
3. Resilience and Sustainability.
4. Art in Public Places.
5. Inter and Intra Regional Tours and Artistic Exchange.
6. First Nations and Multicultural Arts and Culture.
7. Young People and Digital Media.

The framework and planning within it acknowledge the need to support arts and culture in regional and remote WA and provide key priorities to address. The Shire will benefit from this framework with the opportunity for leadership training and development, the assistance with arts and culture projects that create community engagement, ownership and sustainability.

The second priority addresses the need for leadership building across the arts and culture in our communities. It is seen that skilled leaders within communities will provide support, innovation and sharing of knowledge enabling proposed arts and culture projects to be successful and relevant to the localities and people they are servicing. The 3 month leadership program offers excellent opportunity for direct leadership training and mentoring, networking and the development of community arts projects. I have submitted an application and hope to be successful as I see much value in how the training will benefit our whole community.

LGMA Community Development Network “Winning Approaches to Community Development,”

On Thursday 13th August I attended a Local Government Managers Association forum on Community Development hosted by the City of Swan. Topics addressed Shires servicing the needs of all age cohorts within the community, innovative thinking and practise, building community resilience and operational thinking within the local government. Speakers from award winning local government projects presented to the group and delivered views on strategic moves to engage and service community development. There are some projects that I will be looking at for our Shire. The key message was to embrace innovation and not to forget that often seemingly “small things” can be big things in the eyes of your community. The next forum will address Tourism and Marketing your Shire.



Marketing What We Do.

Community Development will be trialling its own column in the Norseman Today. Out and About is marketing at a grass roots level. It is important that the community is informed about the good things that are taking place in their community. The concept is not to *sell* what the Shire does, but to celebrate what our community does.

Shire of Dundas workers were the top ‘trend’ on the local Norseman Discussion Facebook Page this month with over 46 likes. To put this into context on this page there has been no other post *liked* this much for the entire year with the average post receiving 12 likes. This simple photo with the words *Working Together Shire of Dundas and Norseman DHS. Making our town beautiful*, is an example of the small things we already do that need to be shared with the community.

Working Together Shire of Dundas and Norseman DHS. Making our town beautiful.

Committee Meetings Attended.

- Norseman Today
- Community Resource Centre
- Gold Fever Committee
- Visitors Centre

Norseman Visitors Centre: The AGM will be held in October where, as the Community Development Officer, I will submit an application for membership for the Shire of Dundas. Previously the sitting Councillor sat on the committee as an invited guest without voting rights. Becoming a member will allow the Shire's representative to cast votes and have a voice in this important community service and representative. The Visitor Centre plays a key role in how the Shire of Dundas is marketed and our branding. I urge interested Councillors to consider sitting on this important committee and submit an application. Applications are available from the Visitors Centre.

Gold Fever Festival 2015:

Planning for this annual event is well and truly underway. It is pleasing to see the committee made up of representatives from across the community and there is a real sense of working together to provide our community with a well-run enjoyable public event.

Street Appearance.

There has been quite a lot of public discussion around empty homes, derelict buildings and street appeal in particular damaged front fences in the community both on social media and amongst residents.

It was suggested on social media that people write letters to the Shire or come in and share their ideas with the Shire about how we can address this problem. I am investigating some more creative approaches to the situation such as Front Fence competition or Garden Competition however I do believe that is a very real concern to local residents and something that we will need to address with consultation and planning.

Norseman Air-Strip Upgrade

On the 13th August 2015 Member for O'Connor Rick Wilson MP launched a campaign addressing the serious need for the Norseman Airstrip to be upgraded to an all-weather facility. As local residents we all know the vital importance that emergency flight access to remote areas has, not only for local residents but for all who travel across this beautiful but remote home of ours.

Social media campaigns have the ability for all to add their comments and posts so it is important that the local voice of people who know the great importance of this is heard. The online petition can be found at www.rickwilson.com.au. This isn't about politics this is about a quality, sustainable and vital service for the community. Please share the information through your networks to ensure we have as many signatures as we can.

Works Managers Monthly Report August

Construction Gang

Construction on the Hyden Road is continuing although wet weather has caused quite a few problems. Heavy rain fell near the breakaways where a large bushfire had been through last summer. With no undergrowth to slow the water down it filled a large hollow, putting approximately 200-300 mm of water over the road. Eventually traffic was getting bogged there and an effort to build the road up was not successful, so a detour was built around the situation. The situation will be continually monitored waiting for an opportune time to remedy the problem.

A helicopter was hired from Esperance to search for possible gravel pits adjacent to the Hyden Rd, there are some good possibilities at the eastern end of the road and some towards the very western end however there are barren areas around Lake Johnson. Now we have to do exploration on the ground to check the quantity and quality of the material, if positive then start the process of getting permission to "win" gravel.

The demonstration of the Kirby crusher was worthwhile and the material it produced has been sent to be assessed for its possibility as a road making material. The results have not been received yet.

Town Crew

The planting of the remaining shrubs out at the Information Bay is now completed. This was done in conjunction with the School Children as a National Tree Day activity. The area south of the Information Bay has the potential for many projects and now Pania Turner has come aboard we will be steered in the right direction.

The town crew have been involved in clearing a lot of unsightly blocks making it a lot easier to mow them when the time is due. Work has also started on improving the drainage underneath the new carport adjacent to the administration block

Gardeners

They are continuing doing general maintenance, rose pruning has begun. The town oval is being prepared for the Schools Annual Sports Day. Now that spring is nearly upon us the gardeners are coming up with some good ideas to enhance the town.

Below is a picture of the Hyden Road where we are having problems, eventually a fairly extensive detour was built around it. This will remain there until it dries out considerably then it will be reassessed. More than likely it will involve a culvert and large quantities of large rock



Work for the Dole

Again not a lot happening here due to low numbers and this will continue for another six weeks. An effort is being made to pick up leaves that had been raked up quite some time ago. They continue to make crosses for the unmarked graves at the cemetery. They have also built a few more garden beds ready for spring planting.

Programme for 2015-2016

Construction Crew 2015/2016

July August September	October November December	January February March	April May June
RRG Hyden Rd100-110 SLK	RRG Hyden Rd110-120 SLK	Construct Info Bay North	RRG Hyden Rd120-130 SLK
Eyre Hwy Rds maintenance	Town maintenance	C&S Mort Harslett Dr	RRG Hyden Rd130-140 SLK
Expansion of Eucla Refuse Site	Christmas Break	Roberts St/Eyre Hwy	Sheet trans Line
Eucla Airstrip Road	Drainage problem Depot	RRG Hyden Rd120-130 SLK	
Maintenance Eucla Roads	Town hall car Park		
Bulk Rubbish Pickup - Eucla			
Victoria Rocks Rd Widening			

Town Projects 2015/2016

Town/Construction	Footpaths	Reseals	Others
Admin Car Park Drainage	Midura/Morgan to Ramsay - East -	Roberts - Ramsay to Sinclair	Replace piping between sewerage pond and Tin Dam
Prinsep to Talbot (RR08)	Prinsep/Alsop to Crampton - East	Ramsay - Mildura to Simon	Depot Fencing
Battery Rd Phoenix Drive	Others	Alsop - Neville to Simon	Roberts street - drainage design
	Waste Bed 2	Austin - Roberts to Goodliffe	Prinsep Street - Drainage design
	Town Cleanup	Hick - Roberts to Goodliffe	Feasibility Study - CBD to Sewerage ponds
	Bulk Rubbish Pickup - Norseman	Simon - Ramsay to Alsop	Phoenix Park Excavation, painting, lighting
	Town hall car Park	Goodliffe - Ramsay to Austin	Prinsep to Talbot intersection - Landscaping
		Brockman - Ramsay to Crampton	
		Dennison Drive - Crampton	

Above is an annual schedule of budgeted works to be performed this financial year, it is a "working" document and could be changed due to a number of circumstances. The schedule will be updated when this happens with explanations as to why. The construction crews programme has been designed around the annual trip to Eucla in August/September and getting the sealing works all done in one hit late in the summer.

Youth Report for Council – Meeting 18th August 2015

Attendance at the Norseman Youth Centre 11/7 – 15/8/2015

Total Days Open: 23 days

Total # of attendances during this period: 113

Average attendance per day: 4.91

34 youth attended and signed into book during this time.

22 - Male 12 - Female

17 - Aboriginal 17 - Non-Aboriginal

8 – 10-12 year olds

8 – 13 year olds

6 – 14 year olds

3 – 15 year olds

2 – 16 year olds

7 – 17-18 year olds

Activities & Events:

Salmon Gums Morning Tea amongst the Markets: As part of Pania's transition into the role of Community Development Officer, together we worked together to approach the community and organise for a bus to head down to Salmon Gums for their Markets. This was a great activity to introduce Pania to some of the community that she will be working with in her role. Was a great day and was thoroughly enjoyed by all.

Friday Night Sports: Currently Kevin Tucker (Community Church Pastor) holds various sporting activities down at the oval/courts every Friday night. I have had a meeting with him and have discussed with him ways that the Norseman Youth Centre can help him with his sports nights as well as opening up sports to the wider community. At this stage, the Norseman Youth Centre will cover the cost of lights used at the oval and courts on Fridays during Kevin's sports events and starting from Term 4, the Youth Centre will have a range of sporting equipment available for everyone to use and return on the night.

The aim of Friday Night Sports is to get more people active within the community, use the facilities we have in town and hopefully as a result of continued use we can bring together more member of our community and those on FIFO/DIDO roster to start up competitions. If we can increase the number of people using these facilities more often we may have a chance of securing funding to help to upgrade buildings and other infrastructure around the Sports Complex. Articles will be written for the Norseman Today along with photos to support with funding.

What sports can we do?

* Basketball

* Netball

* Tennis

* Squash

* Volleyball

* Boxercise

* Little Athletics

* Football

* Frisbee

Other Comments:

Although a lot of positive things happen with Youth Centre it is not without its challenges. A lot of thought and time goes into organising activities and sports for the Youth of Norseman and unfortunately some of the Youth and their families do not always support the events/activities.

What are the issues the Youth Officer is faced with when organising activities and events...?

- Parental Support – lack thereof. A small number of parents are very active in their involvement whilst others will only go as far as signing a form to give permission for their child to participate. Some days we are unable to get to sporting activities or other events due to lack of parental support with driving of buses or supervision.
- Alcohol and Other Drug issues – both from parents/family members use of AOD affecting the youth and from youth themselves and their peers.
- Financial issues – as most of the youth are from low-socioeconomic families it is hard for them to afford to send their child/children to sporting or school holiday activities. KidSport helps to pay for registrations but some families will still struggle to purchase mouth guards, shoes, uniforms etc for their kids. Some kids even come to activities out of town without money to buy any lunch. To help counteract this all out of town school holiday activities are set at \$10/person. This covers the cost of activities we go to and provides them with lunch and a drink.