

PWD ACCOMMODATION BUILDING

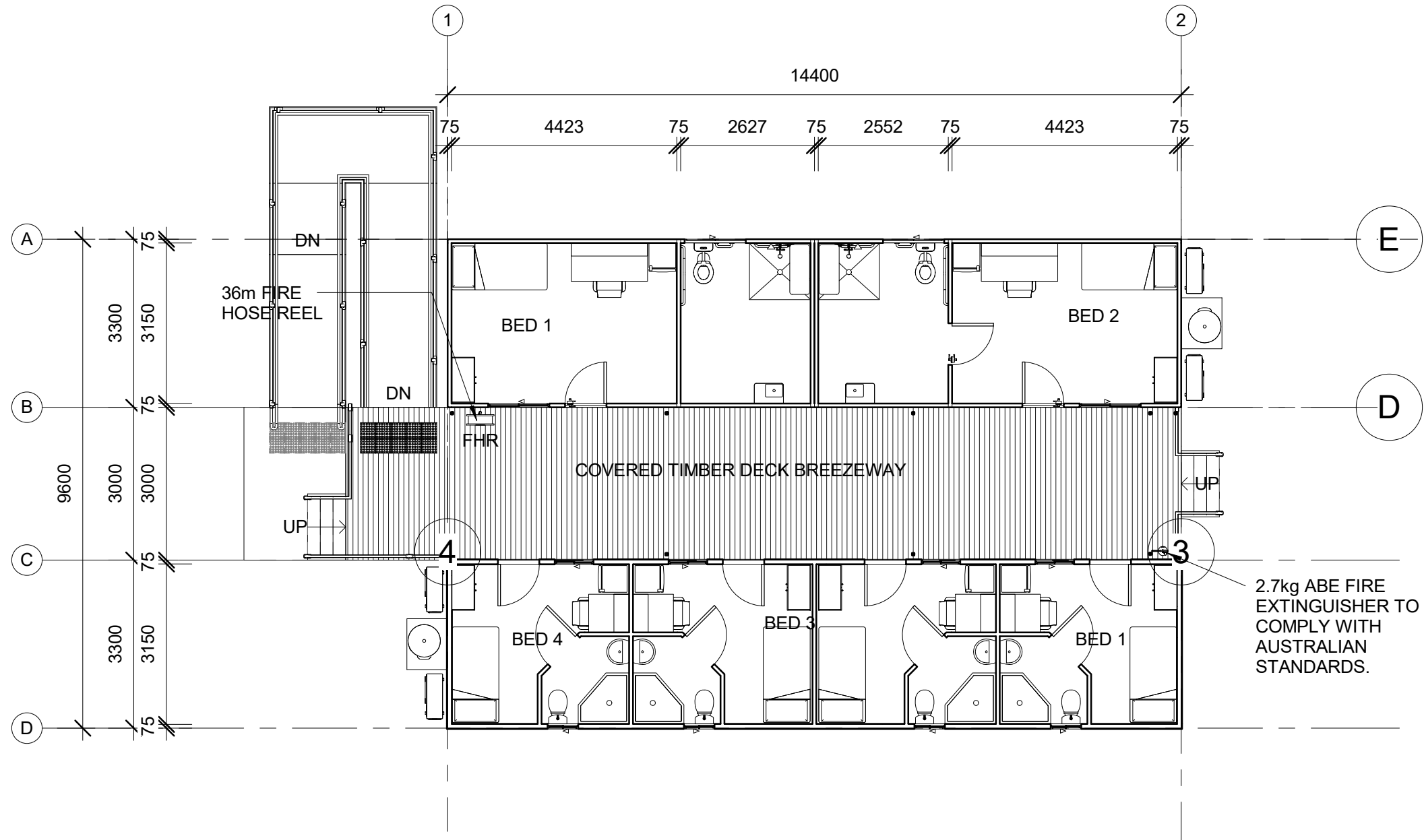

MODULES	95m ²
DECK	43.2m ²
TOTAL m²	138.2m²

TYPICAL PWD ACCOMMODATION PLAN
1 : 100 @ A3

NOTE: TOTAL LENGTH OF BUILDING NOT TO EXCEED 45M. ALL SMOKE ALARMS MUST BE INTERCONNECTED IF MODULES HAVE LESS THAN 1.5M SPACING END TO END.

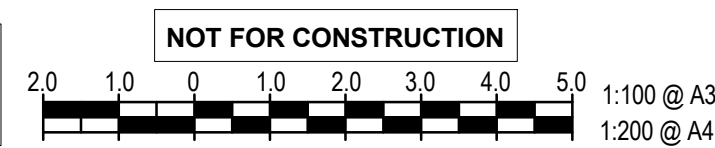

NOTE:
- VERIFY ALL DIMENSIONS ON SITE
- NOTED DIMENSIONS TAKE PRECEDENCE OVER SCALED DIMENSIONS
© COPYRIGHT: ANDRE MELVILLE BUILDING DESIGN & DRAFTING SERVICES (AMBD)
These plans are not to be reproduced wholly or in part without the express written permission of AMBD

PROJECT : PROPOSED ACCOMMODATION VILLAGE
CLIENT : Resource Accommodation Management Pty Ltd
LOCATION: 107-111 PRINSEP ST, 106-114 ANGROVE ST & 51 RICHARDSON ST. NORSEMAN, WA, 6443

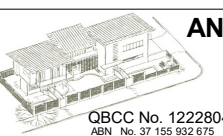

ANDRE MELVILLE BUILDING DESIGN & DRAFTING SERVICES
P.O BOX 8, LABRADOR, QLD 4814
Ph: 0498 001 535
E-MAIL: admin@ambd.com.au
www.ambd.com.au
Townsville - Brisbane - Goldcoast

No.	Description	Date
A	DA APPLICATION	19/11/20

DESIGNED	AM	TYPICAL PWD ACCOMMODATION LAYOUT
DRAWN	AM	
DATE	AUG 2020	
SCALE	A3 1 : 100	
ISSUED	19/11/20	20-126 - SK - SK - 11 - A

19/11/2020 16:38:59 AM